

T.1N.R.3W.W.M.

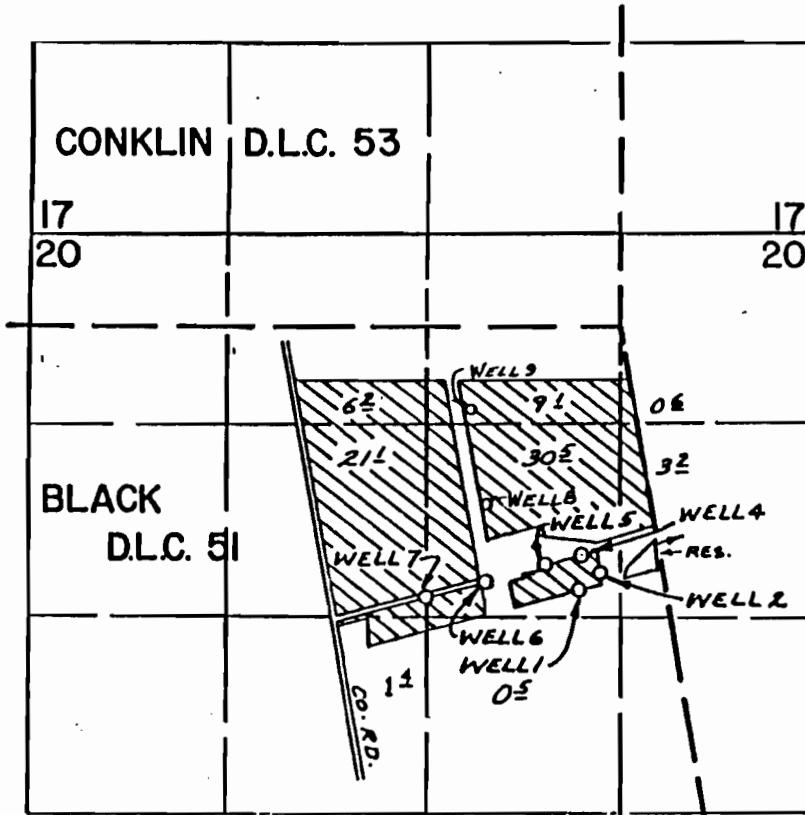

- WELLS LOC
- 01 - 1830'S. & 270'W.
 - 02 - 1720'S. & 150'W.
 - 04 - 1580'S. & 250'W.
 - 05 - 1650'S. & 500'W.
 - 06 - 1770'S. & 900'W.
 - 07 - 1870'S. & 1320'W.
 - 08 - 1230'S. & 900'W.
 - 09 - 560'S. & 1000'W.
- Scale 1"=1320'
- ALL FROM N.E. COR. BLACK D.L.C. 51

DAM LOCATED 500' N & 270' E FROM THE SE COR. SW 1/4 NE 1/4 SEC. 20

Application No. 71339 & 2-12440
Permit No. G12274

WATER RIGHT APPLICATION MAP



PREPARATION OF THIS MAP IS FOR THE PURPOSE OF IDENTIFYING THE LOCATION OF THE WATER RIGHT ONLY. THERE IS NO INTENT TO PROVIDE DIMENSIONS OR LOCATION OF PROPERTY OWNERSHIP LINES.

VERBOORT ENGINEERING
 AGRICULTURE · CIVIL · WATER RESOURCES
 HILLSBORO, OREGON

by date
 designed WRV 2.91
 drawn JER 2.91
 checked _____
 drawing no. 91-A-02
 sheet no. 1/1

OREGON ROSES, INC
 1170 SE T.V. HWY.
 HILLSBORO, OR