

T.15S., R.13E., W.M.
 DESCHUTES COUNTY, OREGON

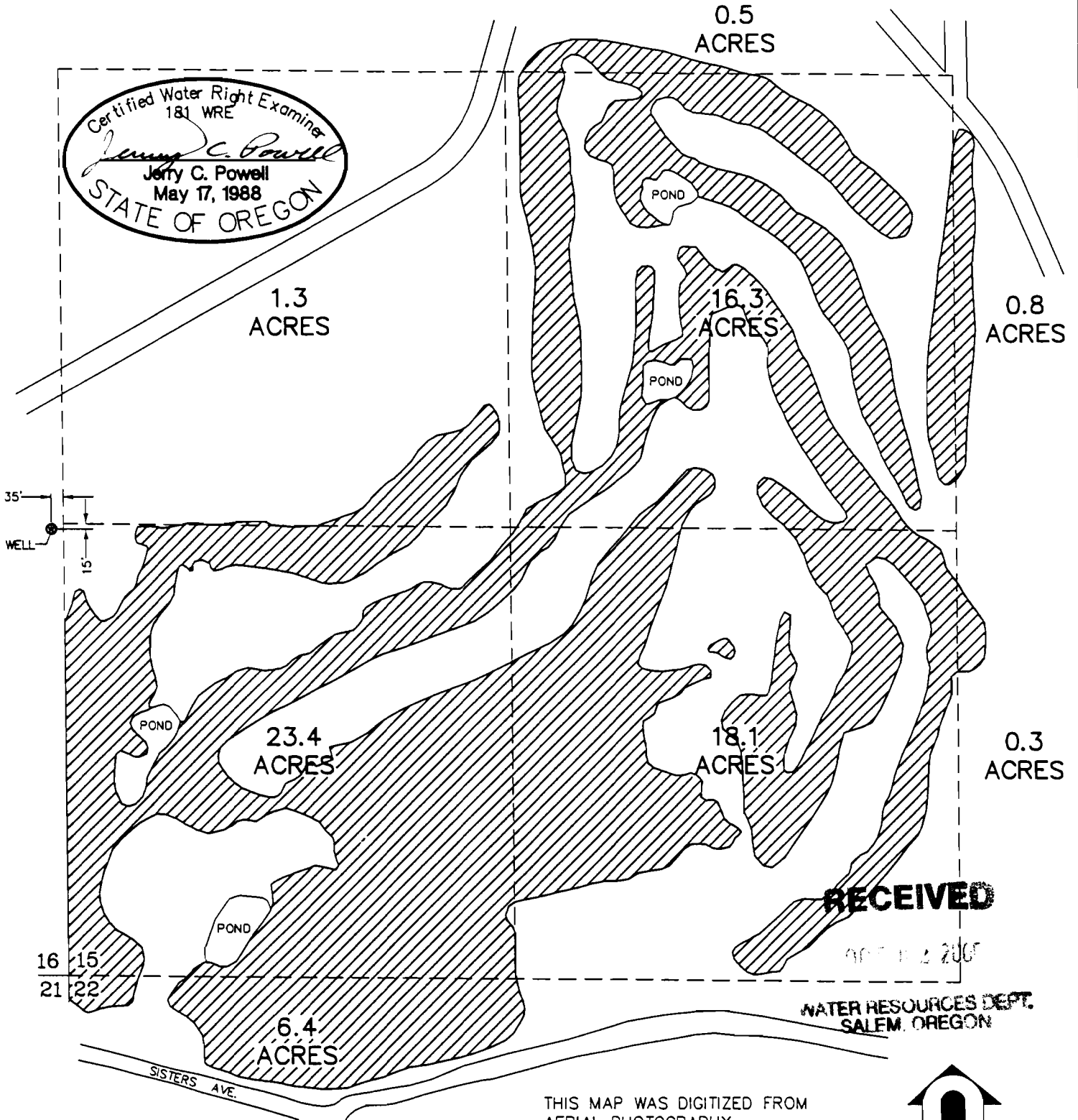
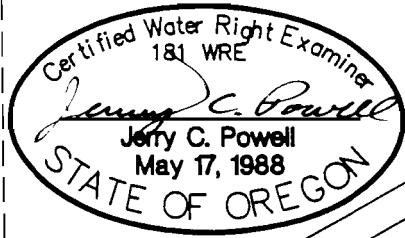
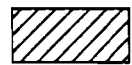

THIS MAP IS FOR THE PURPOSE OF LOCATING A WATER RIGHT AND IS NOT INTENDED TO PROVIDE LEGAL DIMENSIONS FOR PROPERTY BOUNDARIES.

THIS MAP WAS DIGITIZED FROM AERIAL PHOTOGRAPHY

 IRRIGATED AREA (67.1 ACRES)



SCALE: 1" = 400'

scale 1" = 400' design JCP
 date 09/27/00 drawn JHL
 file JGCX0001 - JGCX0001.DWG

DAVID EVANS AND ASSOCIATES, INC.
 709 NW Wall Street, Suite 102
 Bend, Oregon 97701 (541) 389-7614



FINAL PROOF SURVEY FOR REDMOND PUBLIC BUILDING CORPORATION