

T2S, R26E, W. M.,

MORROW COUNTY, OREGON

Application Map for KINZUA CORP.

Rt. 2, Box 2100

Heppner, OR. 97836

Phone No. 676-9183

Application No. C-13249

Permit No. 612370

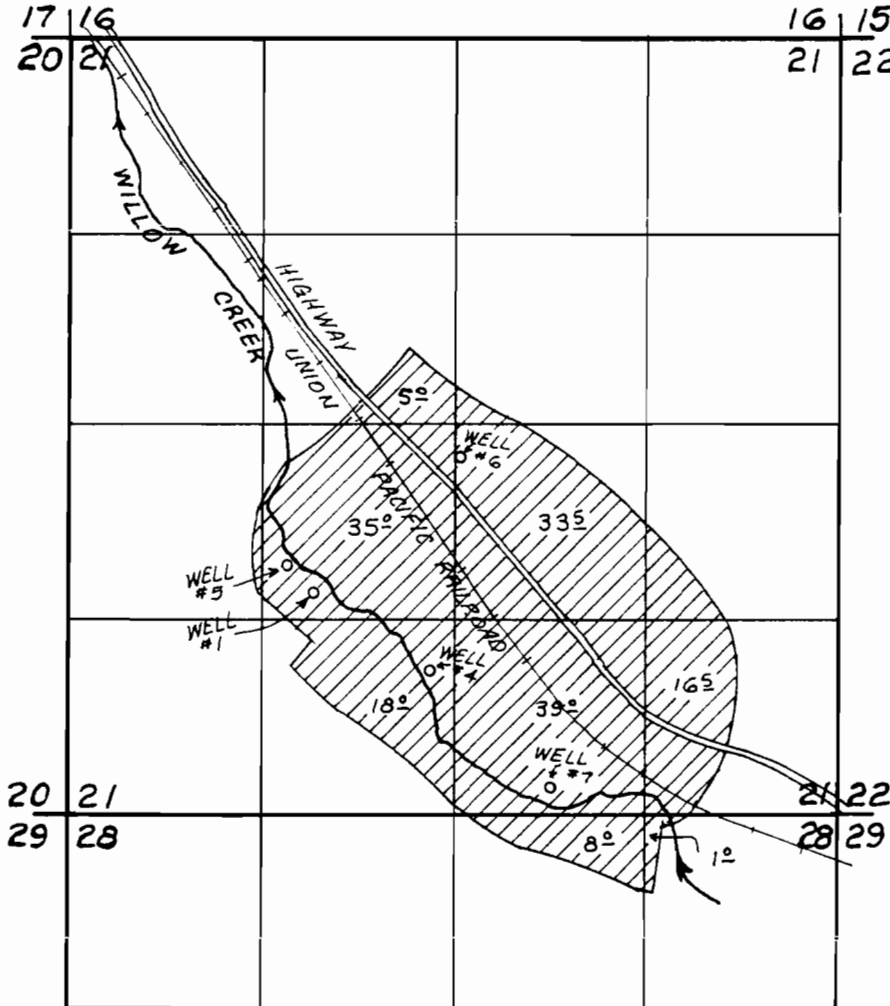

Scale: 1" = 1320'

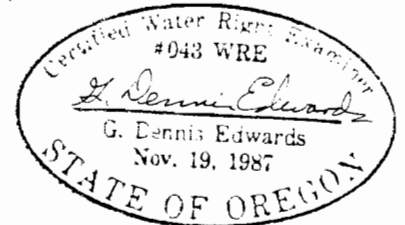

Existing Well #1 lies 1463' N. & 3603' W. of SE corner of Section 21.

Existing Well #4 lies 971' N. & 2840' W. of SE corner of Section 21.

Existing Well #5 lies 1680' N. & 3779' W. of SE corner of Section 21.

Proposed Well #6 lies 2430' N. & 2590' W. of SE corner of Section 21.

Proposed Well #7 lies 220' N. & 1980' W. of SE corner of Section 21.

This map is for identifying the location of water rights only and is not intended to show property lines or dimensions.

Edwards Surveying P.O. Box
567-3336 Hermiston, OR. 97838
12/29/92 Job #W9212087