

T14S, R11E, W.M.
T15S, R11E, W.M.

32

482' 5

1/4

GOV. LOT 3
NE1/4, NW1/4

GOV. LOT 2
NW1/4, NE1/4

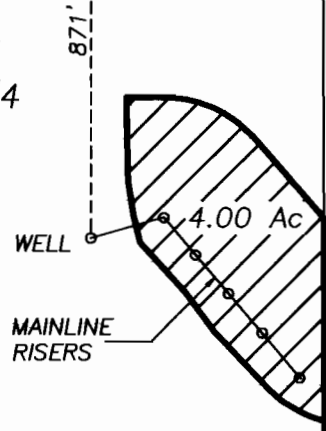

FINAL PROOF SURVEY

APPLICATION No. G-13092
PERMIT No. G-12392

OWNER

DONNA JOHNSON
69089 HOLMES ROAD
SISTERS, OR 97759

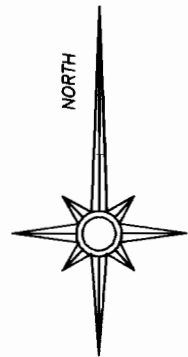

SE1/4, NW1/4

SW1/4, NE1/4

C 1/4

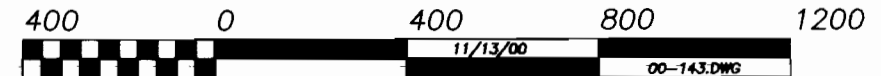

GRAPHIC SCALE: 1"=400'