

**WELL FIELD DETAIL**

N.T.S.

NOTE: GROUND ELEVATIONS DETERMINED FROM CH<sub>2</sub>M DESIGN DRAWINGS FOR WELL FIELD.

Application No. G-13221  
Permit No. G12406



SCALE: 1" = 400'



My license expires 12/31/93

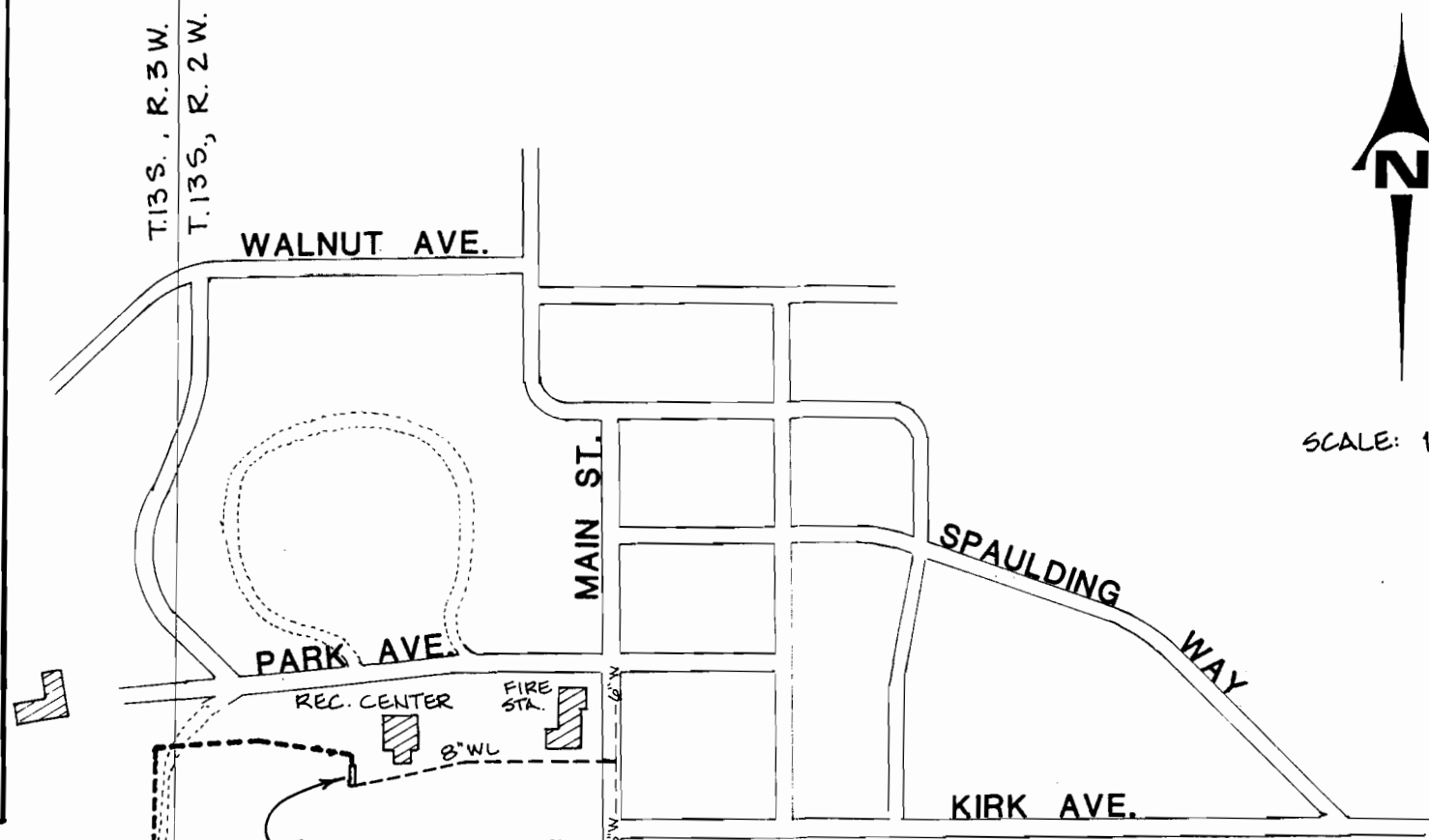

**BOOSTER PUMP STA. & CHLORINATION CHAMBER**  
TWO PUMPS: ① 195 ± g.p.m.  
② 210-215 ± g.p.m.

**P.O.D. #19561  
ABANDONED WELL**

GROUND WATER REGISTRATION No. GR-12  
CERTIFICATE NO. GR-11  
PRIORITY DATE: DEC. 31, 1921  
AMOUNT: 225 gpm (0.5013 cfs)

**P.O.D. #11212  
ABANDONED INFILTRATION GALLERY**

PERMIT No. 27871  
PRIORITY DATE: FEB. 23, 1962  
AMOUNT: 0.67 cfs.  
PROOF OF APPROPRIATION DATE: FEB. 4, 1967  
TRANSFER No.: T-5313 (JULY 6, 1983)

**P.O.D. #11211  
EXISTING INFILTRATION GALLERY**

TWO WATER RIGHTS EXIST:  
1) TRANSFER No. 5313  
PRIORITY DATE: FEB. 23, 1962  
AMOUNT: 0.67 cfs.  
CERTIFICATE OF WATER RIGHT No.: 67874  
TRANSFER FOR ALTERNATE POINT OF APPROPRIATION IS PENDING  
2) PERMIT No. 47733 (APPLICATION No. 65273)  
PRIORITY DATE: JULY 6, 1983  
AMOUNT: 0.58 cfs.

**EXISTING WELL FIELD  
(GROUND WATER SOURCES)**

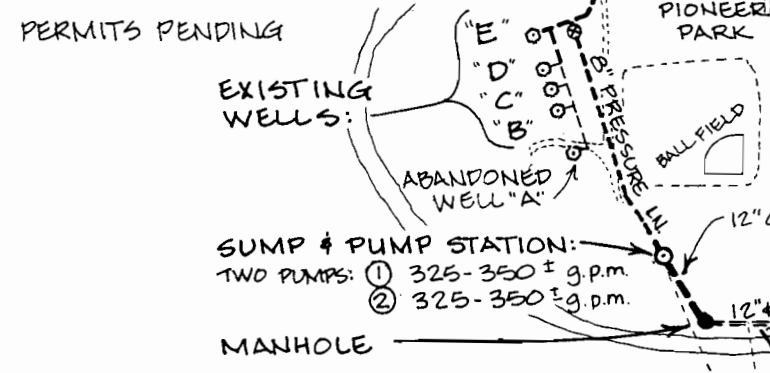

**POINTS OF DIVERSION:**

(TIE FROM SW. COR. SEC. 31)

**GROUND WATER:**

- WELL "B" - (N. 28° 30' W. 1020')
- WELL "C" - (N. 28° W. 1070')
- WELL "D" - (N. 27° 30' W. 1110')
- WELL "E" - (N. 27° W. 1190')

**SURFACE WATER:**

- INFILTRATION GALLERY (E) - (N. 10° W. 470')
- PUMPING POINT - (N. 25° W. 660')

DEC 17 1992

WATER RESOURCES DEPT.  
SALEM, OREGON

**KD ENGINEERING, INC.**  
202 NW HICKORY STREET  
POST OFFICE BOX 725  
ALBANY, OREGON 97321

**BROWNSVILLE WATER RIGHTS**  
Sec. 31, T. 13 S., R. 2 W. & Sec. 36, T. 13 S., R. 3 W., W.M.  
BROWNSVILLE, LINN COUNTY, OREGON

DSGN. BY:	SCALE: 1" = 400'	SHEET NO.
DWG. BY: M.M.S.	DATE: DEC. 10, 1992	
CKD. BY: J.R.B.	PROJECT NO.: 92-06-07	