

# T.4S. R.1W., W.M

## RECEIVED

JUL 24 1998

WATER RESOURCES DEPT  
SALEM, OREGON

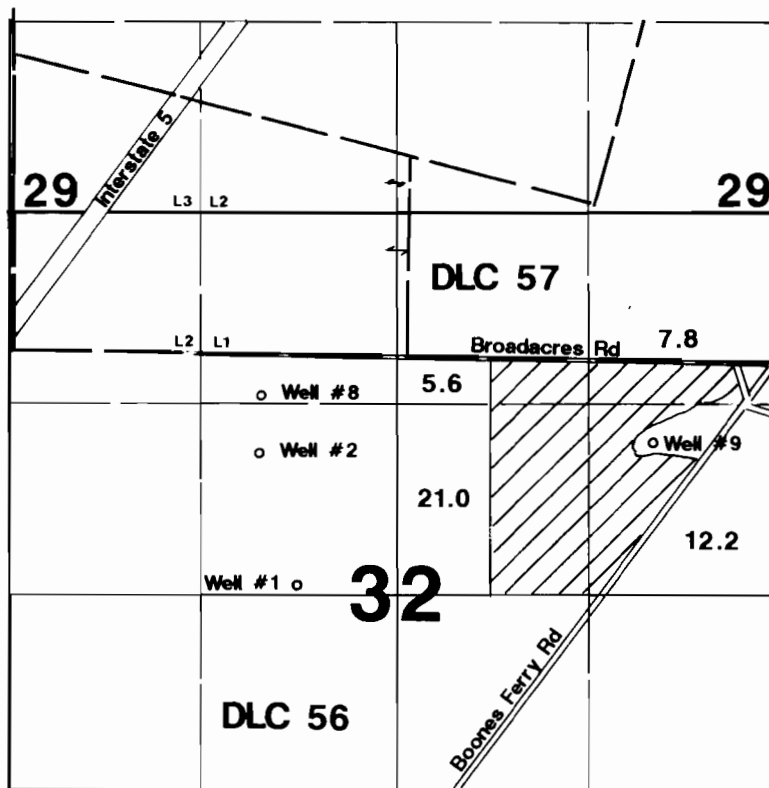

Well # 1 is located 60'N & 1950'E from W1/4 corner Section 32.  
Well # 2 is located 980'N & 1650'E from W1/4 corner Section 32.  
Well # 8 is located 1380'N & 920'W from center Section 32.  
Well # 9 is located 540'S & 860'W from NE corner DLC 56.

## Final Proof Survey

Application #: G-13872 Permit #: G-12409

In Name Of

**Tom DeArmond**

Surveyed on July 14, 1998 by JM Schuette

This Map Was Prepared For The Purpose Of Identifying The  
Location Of A Water Right Only And Is Not Intended To Provide  
Legal Dimensions Or Location Of Property Ownership Lines.

