

FINAL PROOF SURVEY

SECTION 15, TOWNSHIP 1 SOUTH, RANGE 3 EAST, W.M.
MULTNOMAH COUNTY

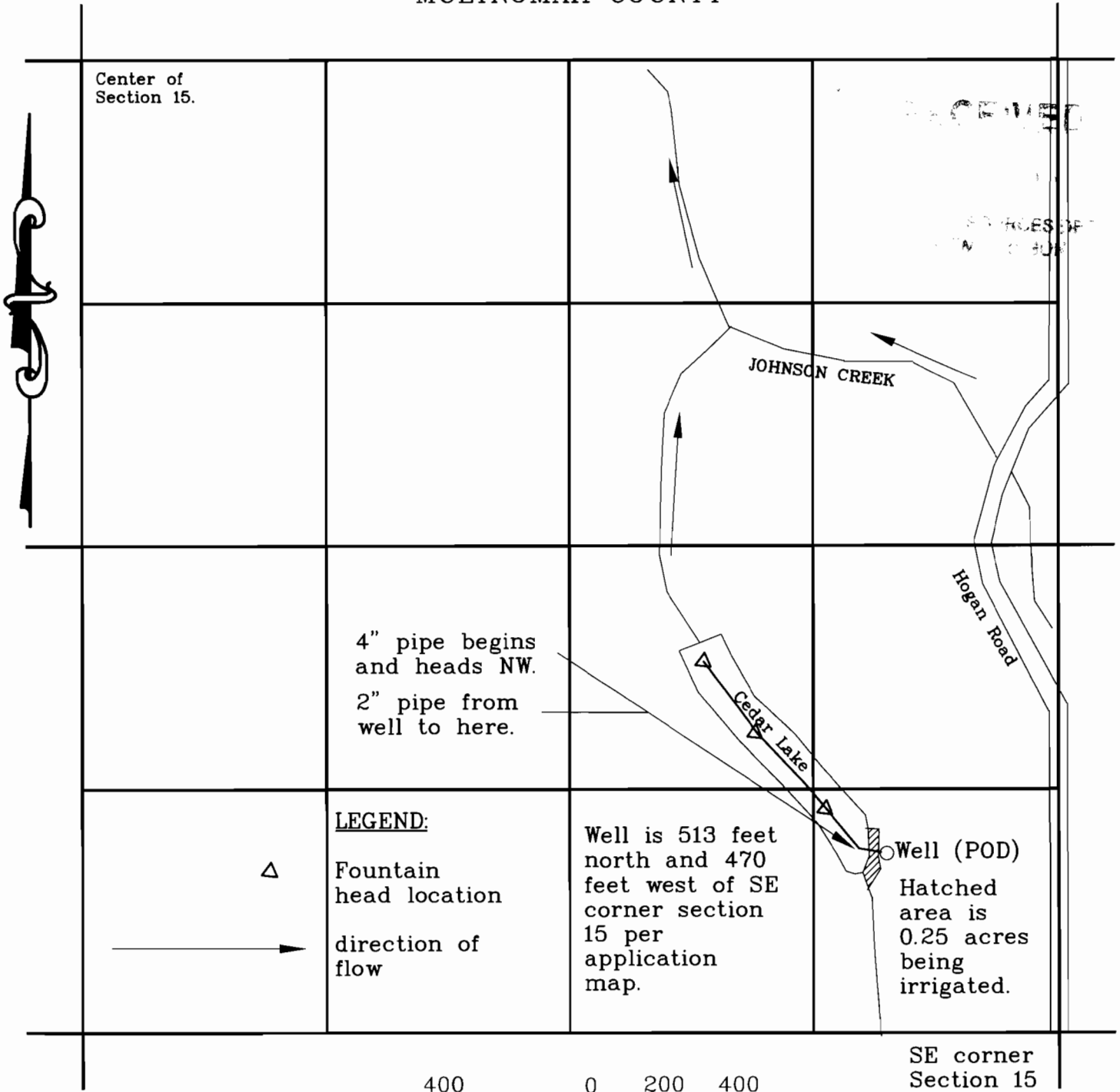

IN THE NAME OF:

Les Brown

Inspected on January 21, 2004

by Eric A. Urstadt



EXAMINERS DISCLAIMER STATEMENT

The preparation of this map was for the purpose of identifying the location of the Water Right only and has no intent to provide dimensions or location of property ownership lines.