

Expires 6-30-08



1" = 1320'

RECEIVED

MAR 20 2007

**WATER RESOURCES DEP
SALEM, OREGON**

PROPERTY OWNER(S) AND APPLICANT(S):
CASCADE HIGHLANDS LIMITED PARTNERSHIP
(HIGHLANDS AT BROKEN TOP PROPERTY)

ARROWOOD DEVELOPMENT
(CASCADE HIGHLANDS RESORT PROPERTY)

NOTE: THIS MAP WAS PREPARED FOR THE
PURPOSE OF IDENTIFYING THE LOCATION
OF WATER RIGHTS. THIS MAP IS NOT
INTENDED TO PROVIDE DIMENSIONS OR THE
LOCATION OF PROPERTY OWNERSHIP LINES.

Office: BEND / System: WRP-BND-12PCEZ1 / User: DWALKER

DESIGNED BY:	CHECKED BY:	TW		
DRAWN BY:	APPROVED BY:			
LAST EDIT:	01/30/07	PLOT DATE: 01/30/07		
DATE	BY	REV	REVISION	CK'D/APP'R

600 Emory, Suite C-100
Bend, Oregon
97702-1441
(503) 338-2000
(503) 338-2002 Fax
w@w&h.com

APPLICATION MAP
for
ASSIGNMENT OF PERMIT G-12494
(APPLICATION #: 12971)
Township 17 and 18 South, Range 11 East
DESCHUTES COUNTY OREGON

BEND	PROJECT NO. 30842	DRAWING FILE NAME: 634810-bnd-12pce-z1-wr1.0	SHEET WR1.0
SCALE: 1" = 1320'			

SEE SHEET WR1.0

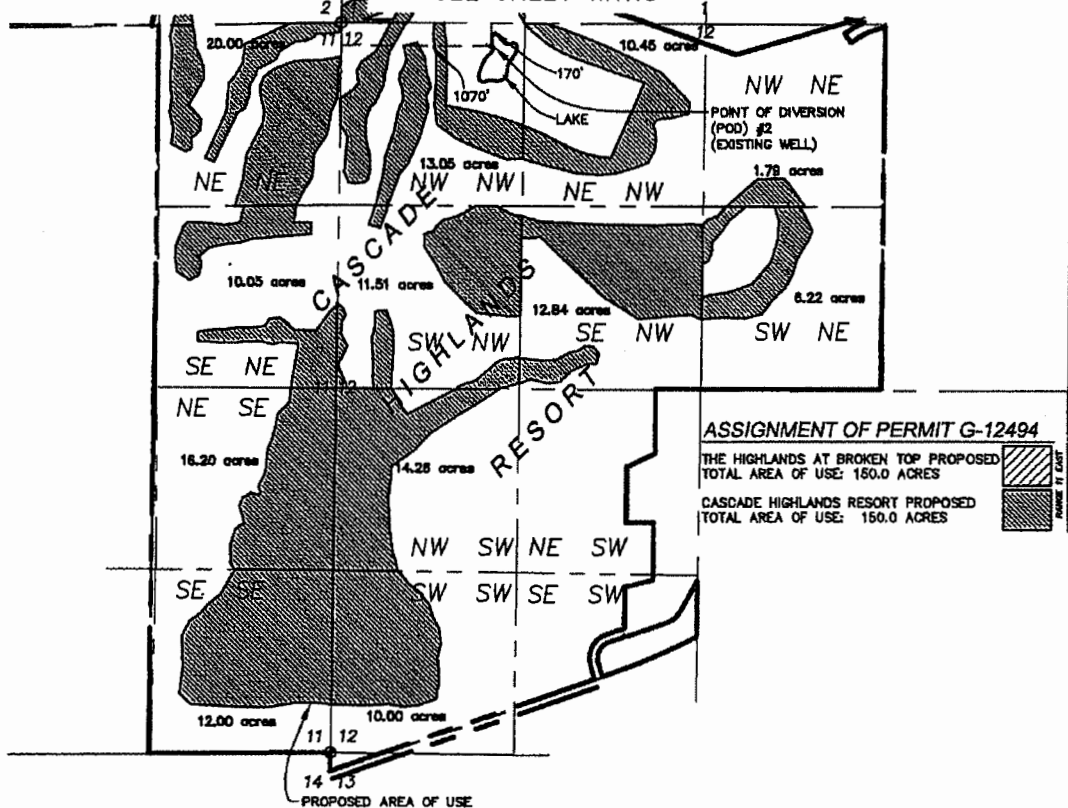

RECEIVED

MAR 20 2007

WATER RESOURCES DEPT
SALEM, OREGON

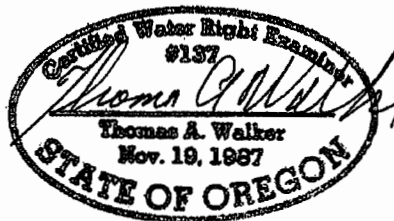

Expires 6.30.08



1" = 1320'

PROPERTY OWNER AND APPLICANT:
CASCADE HIGHLANDS LIMITED PARTNERSHIP

NOTE: THIS MAP WAS PREPARED FOR THE PURPOSE OF IDENTIFYING THE LOCATION OF WATER RIGHTS. THIS MAP IS NOT INTENDED TO PROVIDE DIMENSIONS OR THE LOCATION OF PROPERTY OWNERSHIP LINES.

Office: BEND / System: WHP-BND-12FCB21 / User: DWALKER

DESIGNED BY:	CHECKED BY:	TW		
DRAWN BY:	APPROVED BY:	NWB		
LAST EDIT:	PLOT DATE:	01/30/07		
DATE	BY	REV	REVISION	CK'D/APPR.

W&H
ENGINEERS

280 Oakway, Suite C-100
Bend, Oregon
97702-1041

(503) 338-4444
(503) 338-4444 Fax
www.wandh.com

APPLICATION MAP
for
ASSIGNMENT OF PERMIT G-12494
(APPLICATION #:12971)
Township 17 and 18 South, Range 11 East

BEND DESCHUTES COUNTY OREGON

SCALE: 1"=1320'

PROJECT NO. 30842

DRAWING FILE NAME: 234910-land-4016-rwd water rights map

SHEET WR2.0