

T18S, R12E, W.M.

WELL #1: 270'W AND 320'S FROM THE NE CORNER OF THE NW¼ OF SEC 17

WELL #2: 320'W AND 300'S FROM THE NE CORNER OF THE NW¼ OF SEC 17

WELL #3: 820'W AND 140'S FROM THE NW CORNER OF SEC 17

WELL #4: 835'W AND 55'S FROM THE NW CORNER OF SEC 17

WELL #9: 630'W AND 160'N FROM THE NW CORNER OF SEC 17

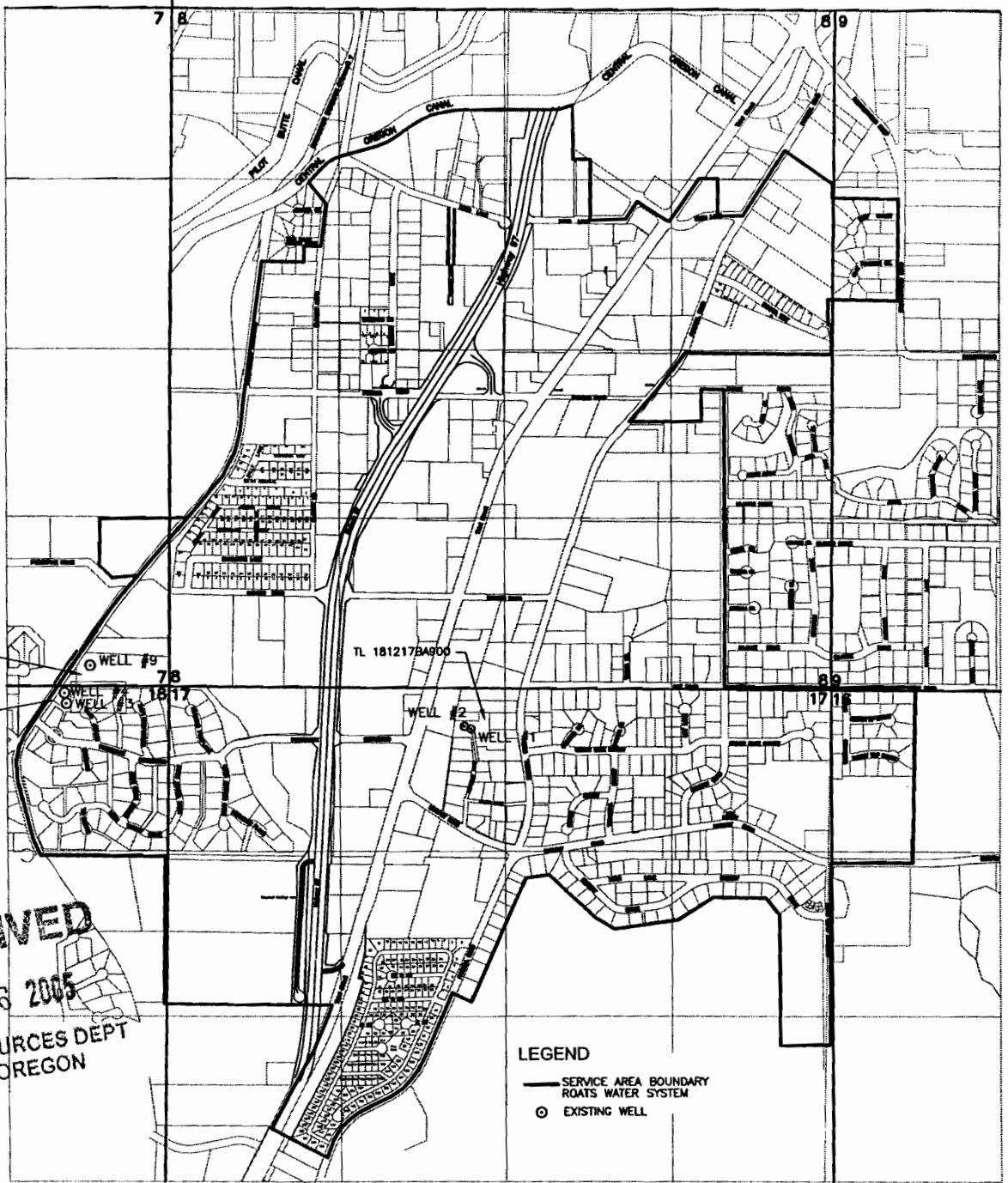

TL 1812070D3100

TL 181218AA100

TL 181217BA900

RECEIVED
JUN 16 2005
WATER RESOURCES DEPT
SALEM, OREGON

LEGEND
— SERVICE AREA BOUNDARY
— ROATS WATER SYSTEM
○ EXISTING WELL

Certified Water Right Examiner
445WRE
Terry Ann Sprecher
Terry Ann Sprecher
06/13/97
STATE OF OREGON

THE PURPOSE OF THIS MAP IS TO IDENTIFY THE LOCATION OF THE WATER RIGHT. IT IS NOT INTENDED TO PROVIDE INFORMATION RELATIVE TO THE LOCATION OF PROPERTY OWNERSHIP BOUNDARY LINES.

TRANSFER APPLICATION:
APPLICATION G-1961, PERMIT G-1890
APPLICATION G-3328, PERMIT G-3128
PERMIT AMENDMENT APPLICATION:
APPLICATION G-13072, PERMIT G-12526



SCALE: 4" = 1 MILE

Project #: 80136.000
Date: MAR 2005
PBS

ROATS WATER SYSTEM, INC.
LOCATION OF EXISTING WELLS
BEND, OREGON

ATTACHMENT
5

T-9954

RECEIVED

JUN 16 2005

**WATER RESOURCES DEPT
SALEM OREGON**

T18S, R12E, W.M.

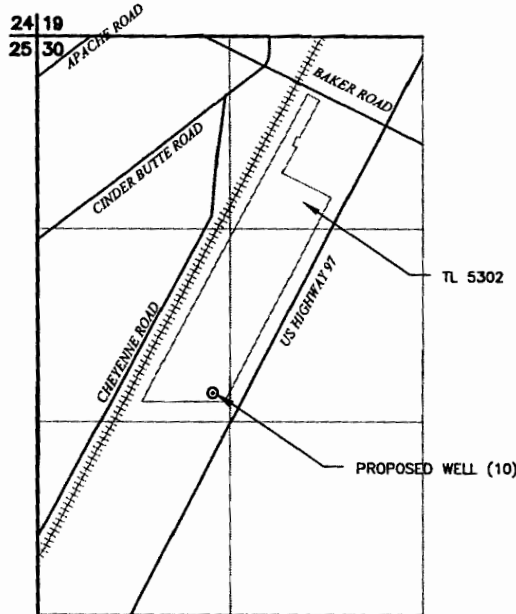

PROPOSED WELL LOCATED
1200'E AND 2445'S OF THE
NW¼ OF SEC 30

LEGEND

- +++++ RAILROAD TRACKS
- ⊙ PROPOSED WELL

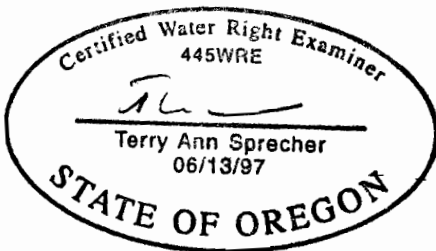

THE PURPOSE OF THIS MAP IS TO IDENTIFY THE LOCATION OF THE WATER RIGHT. IT IS NOT INTENDED TO PROVIDE INFORMATION RELATIVE TO THE LOCATION OF PROPERTY OWNERSHIP BOUNDARY LINES.

TRANSFER APPLICATION:

APPLICATION G-1961, PERMIT G-1890

APPLICATION G-3328, PERMIT G-3128

PERMIT AMENDMENT APPLICATION:

APPLICATION G-13072, PERMIT G-12526



SCALE: 4" = 1 MILE



Project #:
80136.000

Date:
MAR 2005

ROATS WATER SYSTEM INC.

PROPOSED WELL LOCATION
DESCHUTES COUNTY, OREGON

ATTACHMENT

6

T-9954