

FINAL PROOF SURVEY FOR FLOREINE HUDSPETH, LOCATED IN THE S1/2 OF SEC. 33, T.14S., R.16E., W.M., CROOK COUNTY, OREGON

RECEIVED

JAN 21 2003

WATER RESOURCES DEPT. SALEM, OREGON

PREPARED FOR FLOREINE HUDSPETH P.O. BOX 628 PRINEVILLE, OR 97754

PREPARED BY ARMSTRONG SURVEYING & ENGINEERING, INC. 378 NE SECOND STREET PRINEVILLE, OR 97754 (541) 447-7791

MAP NOTE

THE PREPARATION OF THIS MAP IS FOR THE PURPOSE OF IDENTIFYING THE LOCATION OF THE WATER RIGHT ONLY AND HAS NO INTENT TO PROVIDE DIMENSIONS OR LOCATIONS OF PROPERTY OWNERSHIP LINES.

ATTORNEY STEPHEN D. DIXON 1070 N.W. BOND STREET SUITE 303 BEND, OR 97701 (541) 389-1770

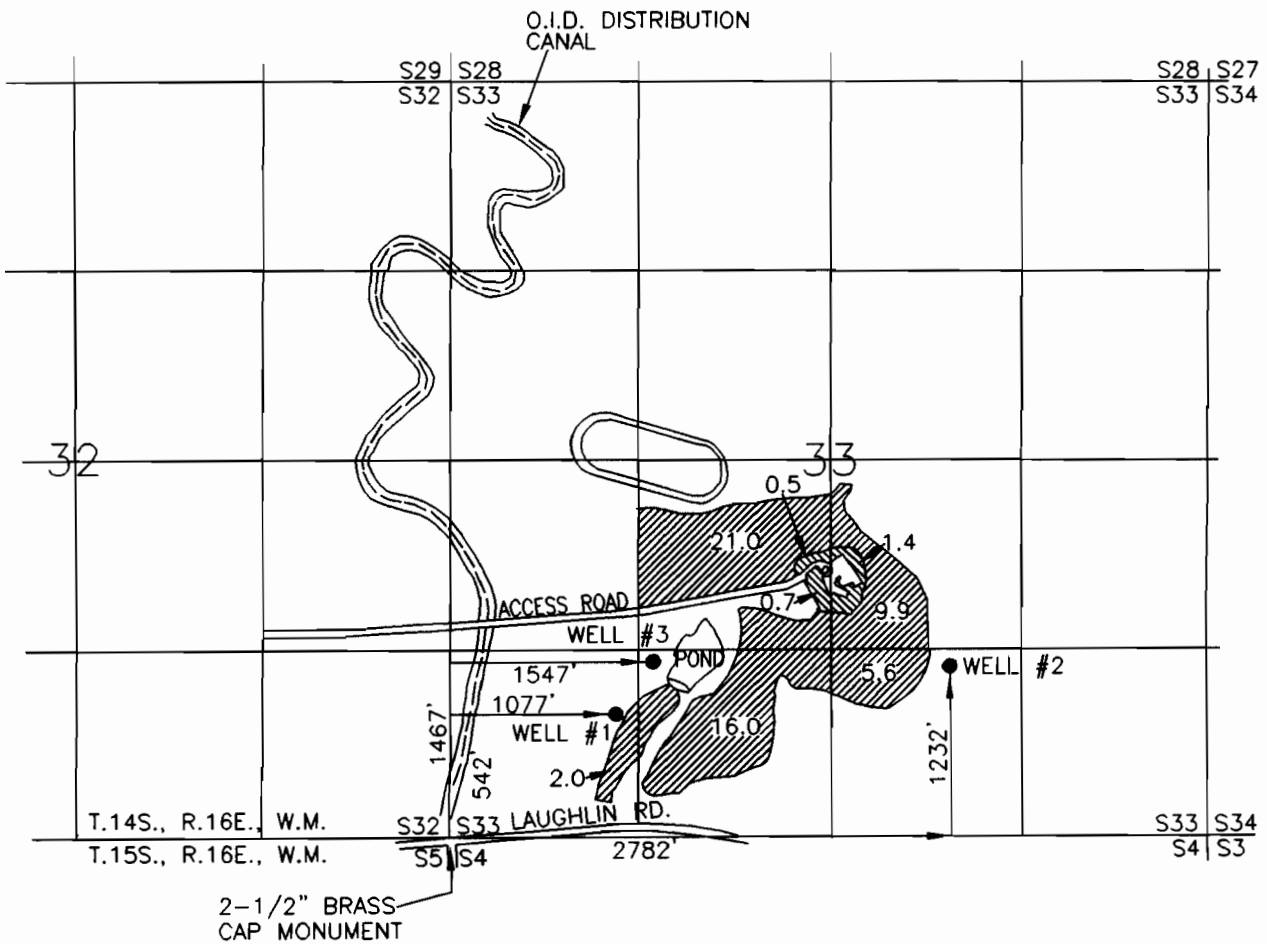

LEGEND

- SUPPLEMENTAL GROUND WATER FROM WELLS NO. 1, 2 AND 3
- PRIMARY GROUND WATER FROM WELL NO. 2

WELL LOCATIONS

FROM THE S.W. COR. OF SEC. 33, T.14S., R.16E., W.M. WELL NO. 1 - NORTH 542 FT. & EAST 1077 FT. WELL NO. 2 - NORTH 1232 FT. & EAST 2782 FT. WELL NO. 3 - NORTH 1467 FT. & EAST 1547 FT.

SCALE 1" = 1320'

