

# CLAIM OF BENEFICIAL USE MAP FOR GROUND WATER RIGHTS IN THE NAME OF WILLIAM V. HILL





Application # G-13657

Permit # G-12619

LOCATED IN THE SE¼, SEC. 15, N½ NE¼, SEC 22, S½ & NW¼. SEC 23, N½, SEC 26, NE¼NE¼, SEC 27, T. 36S, R. 14E., W.M. KLAMATH COUNTY, OREGON

## LEGEND

PRIMARY

-  SUPPLEMENTAL TO CERTIFICATE #9953 & #33926
-  SUPPLEMENTAL TO CERTIFICATE #9964
-  SUPPLEMENTAL TO CERTIFICATE #9974 & #33926
-  SUPPLEMENTAL TO CERTIFICATE #31365
-  SUPPLEMENTAL TO CERTIFICATE #9952, #21416 & #33926
- 10.0 ACREAGE

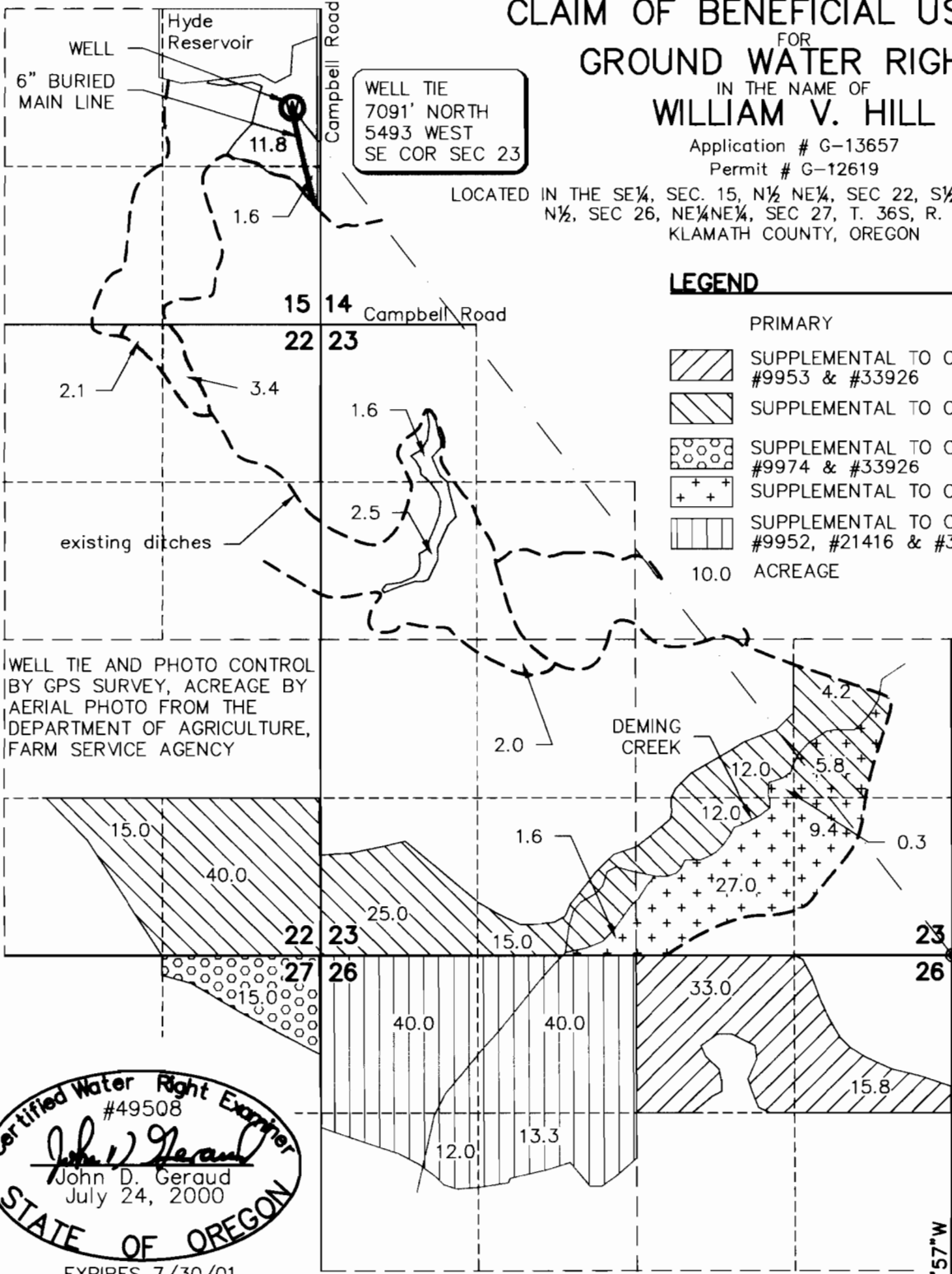

WELL TIE AND PHOTO CONTROL BY GPS SURVEY, ACREAGE BY AERIAL PHOTO FROM THE DEPARTMENT OF AGRICULTURE, FARM SERVICE AGENCY

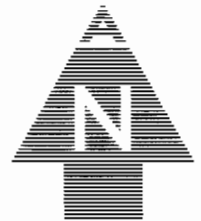

SCALE: 1" = 1320'

FOUND MONUMENT PER CS 2431

**RECEIVED**

SEP 28 2000

WATER RESOURCES DIVISION  
SALEM, OREGON

Certified Water Right Examiner  
#49508  
*John D. Geraud*  
John D. Geraud  
July 24, 2000  
STATE OF OREGON  
EXPIRES 7/30/01

THIS MAP IS FOR THE PURPOSE OF IDENTIFYING THE LOCATION OF THE WATER RIGHT ONLY AND HAS NO INTENT TO PROVIDE DIMENSIONS OR LOCATION OF PROPERTY LINES.

FOUND MONUMENT PER CS 2162

S00°23'57"W  
5354.81'

Engineers ▲ Planners ▲ Surveyors

**ADKINS**

CONSULTING ENGINEERS, INC.

2950 Shasta Way · Klamath Falls, Oregon 97603 · (541) 884-4666 · FAX (541) 884-5335

September 20, 2000

Klamath Falls, OR · Medford, OR · Alturas, CA

JOB No. 2257-01