

Application No. ~~611492~~
612630
Permit No. ~~1-6424~~

JUL 17 1994

T.14S., R.14E., W.M.

CROOK COUNTY

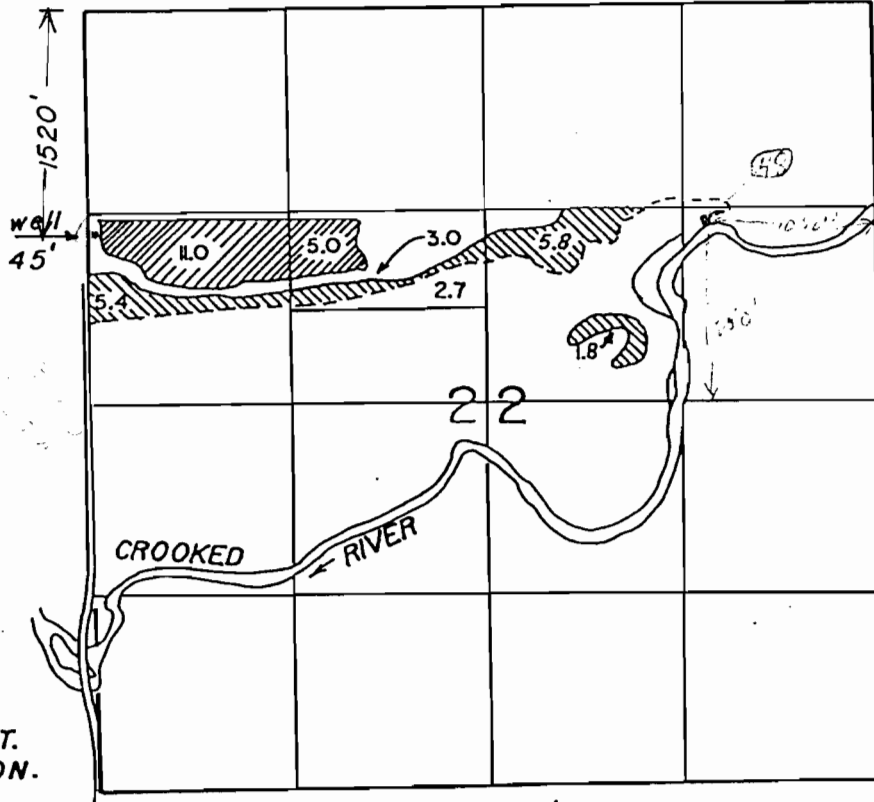

16.0 AC. of CERT.
57614 W/R- ON.

SCALE: 1" = 1320'

16.0 AC. of CERT.
57614 W/R- OFF,
to be replaced by
G-11492 W/R.

APPLICATION MAP
FOR WATER RIGHT TRANSFER
SCHLOSSER TO SCHLOSSER

RECEIVED

SEP - 5 1990

WATER RESOURCES DEPT.
SALEM, OREGON

I, Robert R. Povey, Oregon Certified Water Right Examiner #106, hereby certify the above application map was prepared under my direct supervision.

The preparation of this map is for the purpose of identifying the location of the water right only and has no intent to provide dimensions or locations of property ownership lines.

