

FINAL PROOF SURVEY

SITUATED IN THE E1/2 OF THE NE1/4
OF SECTION 34, T34S, R8EWM,
KLAMATH COUNTY, OREGON
DECEMBER, 2004

RECEIVED

DEC 29 2004

WATER RESOURCES DEPT
SALEM, OREGON

MAP PREPARED FROM
AERIAL PHOTOGRAPH

PERMIT #G-12638

APPLICATION #G-13858

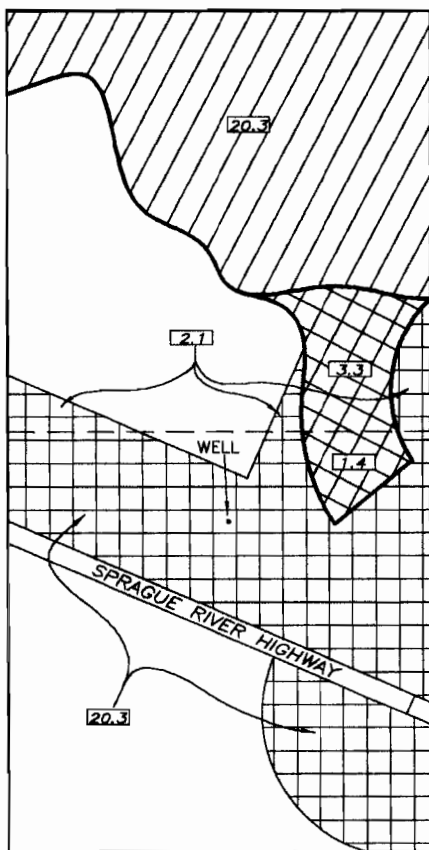

C1/4
34|35



SCALE
1' = 600'

TOTAL AREA
--47.4 ACRES--

MAP PREPARED FOR
--DAVID ROGERS--

LOCATION OF WELL BY FIELD INSPECTION

N72°37'00"W 3433 FEET TO THE CENTER
QUARTER CORNER OF SECTION 35



PRIMARY LANDS THIS SURVEY
SPRINKLER IRRIGATED 22.4 Ac.



PRIMARY LANDS THIS SURVEY
FLOOD IRRIGATED 4.7 Ac.



LANDS SUPPLEMENTAL TO THE
WATER RIGHT CERTIFICATE RECORDED
IN VOLUME 25, PAGE 33,614 20.3 Ac.

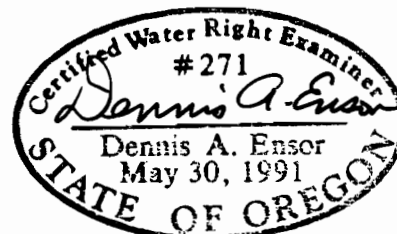

EXPIRES: 12/31/05

THE PURPOSE OF THIS MAP IS TO IDENTIFY
THE LOCATION OF THE WATER RIGHT. IT IS NOT
INTENDED TO PROVIDE INFORMATION RELATIVE TO
THE LOCATION OF PROPERTY OWNERSHIP BOUNDARY
LINES.

TRU-LINE SURVEYING, INC.
2333 SUMMERS LANE
KLAMATH FALLS, OREGON 97603