

Application No. G-12901
 Permit No.
 APPLICATION MAP



IN THE NAME OF WILLIAM OR JEAN SOPER

SECTION 4, TOWNSHIP 28 SOUTH, RANGE 14 WEST, W.M.

1 INCH = 1320 FEET

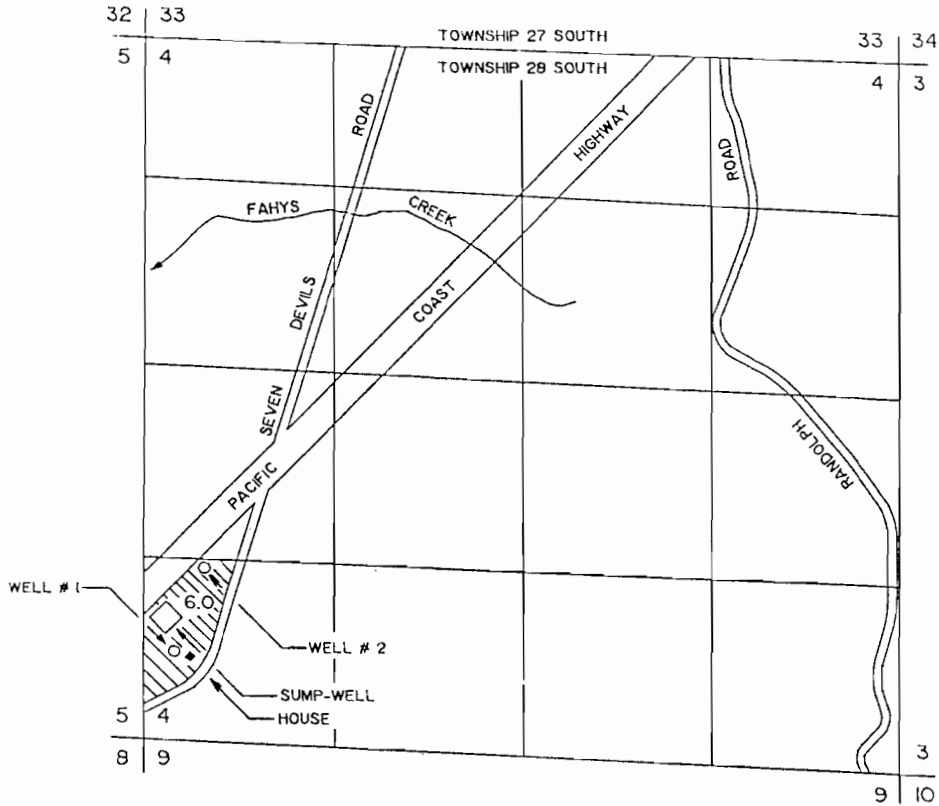

G12904
 G12725

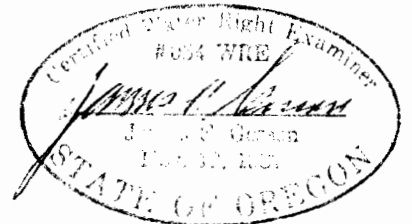

WELL #1 IS TO BE LOCATED 600 FEET NORTH AND 200 FEET EAST. WELL #2 IS TO BE LOCATED 1200 FEET NORTH AND 420 FEET EAST. THE SUMP WELL IS TO BE LOCATED 850 FEET NORTH AND 150 FEET EAST; ALL FROM THE SOUTHWEST CORNER OF SECTION 4; AND ALL BEING WITHIN THE SW 1/4 OF THE SW 1/4 OF SECTION 4, TOWNSHIP 28 SOUTH, RANGE 14 WEST, W.M., COOS COUNTY.

THE PURPOSE OF THIS MAP IS TO IDENTIFY THE LOCATION OF THE WATER RIGHT. IT IS NOT INTENDED TO PROVIDE INFORMATION RELATIVE TO THE LOCATION OF PROPERTY OWNERSHIP BOUNDARY LINES.