

T4&5 N R25&26 E., W.M.
MORROW COUNTY, OREGON

Scale: 1" = 1320'
LAKE UMATILLA
COLUMBIA RIVER

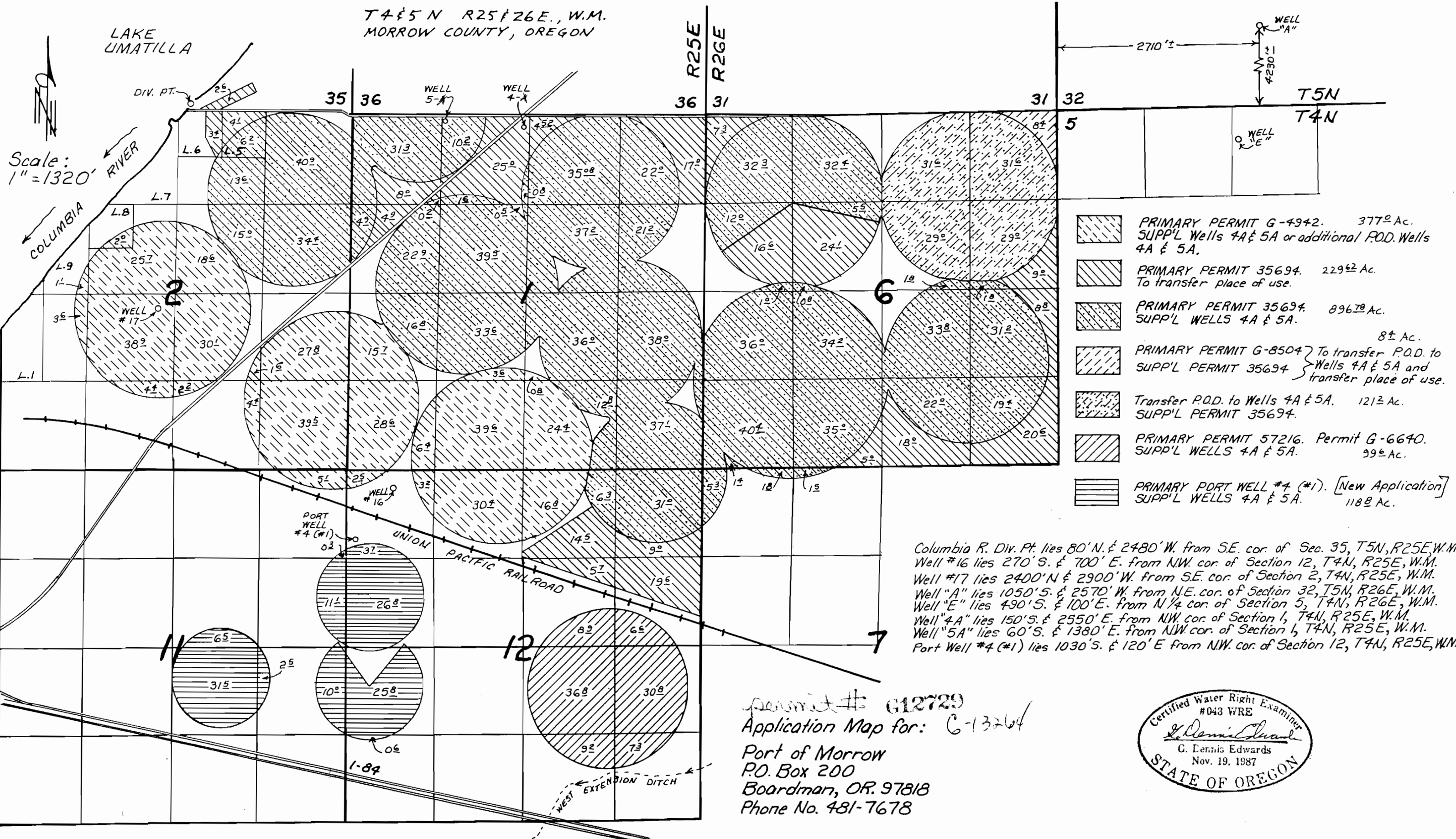

- PRIMARY PERMIT G-4942. 377⁰ Ac.
SUPPL' Wells 4A & 5A or additional P.O.D. Wells 4A & 5A.
- PRIMARY PERMIT 35694. 229⁶² Ac.
To transfer place of use.
- PRIMARY PERMIT 35694. 896⁷⁸ Ac.
SUPPL' WELLS 4A & 5A.
- PRIMARY PERMIT G-8504 } To transfer P.O.D. to
SUPPL' PERMIT 35694 } Wells 4A & 5A and
transfer place of use. 8[±] Ac.
- Transfer P.O.D. to Wells 4A & 5A. 121[±] Ac.
SUPPL' PERMIT 35694.
- PRIMARY PERMIT 57216. Permit G-6640.
SUPPL' WELLS 4A & 5A. 99[±] Ac.
- PRIMARY PORT WELL #4 (#1). [New Application]
SUPPL' WELLS 4A & 5A. 118[±] Ac.

Columbia R. Div. Pt. lies 80' N. & 2480' W. from S.E. cor. of Sec. 35, T5N, R25E, W.M.
Well #16 lies 270' S. & 700' E. from N.W. cor. of Section 12, T4N, R25E, W.M.
Well #17 lies 2400' N & 2900' W. from S.E. cor. of Section 2, T4N, R25E, W.M.
Well "A" lies 1050' S. & 2570' W. from N.E. cor. of Section 32, T5N, R26E, W.M.
Well "E" lies 490' S. & 100' E. from N 1/4 cor. of Section 5, T4N, R26E, W.M.
Well "4A" lies 150' S. & 2550' E. from N.W. cor. of Section 1, T4N, R25E, W.M.
Well "5A" lies 60' S. & 1380' E. from N.W. cor. of Section 1, T4N, R25E, W.M.
Port Well #4 (#1) lies 1030' S. & 120' E from N.W. cor. of Section 12, T4N, R25E, W.M.

permit # G12729
Application Map for: C-13264
Port of Morrow
P.O. Box 200
Boardman, OR. 97818
Phone No. 481-7678

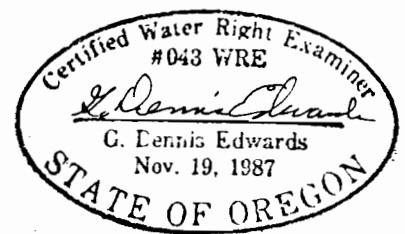

This map is for identifying the location of water rights only and is not intended to show property lines or dimensions.

Edwards Surveying P.O. Box 763
567-3336 Hermiston, OR. 97838
1/13/93 Job #W9212084-A