

RECEIVED

MAY 1995

WATER RIGHT APPLICATION MAP

T. 36 S. R. 6 W. SEC. 27 W.M.



APPLICATION NO. G-14020

APPLICANTS:
ROBERT P. & REBECCA HAMILTON
5293 FISH HATCHERY RD.
GRANTS PASS, OR. 97527

PERMIT NO. G12754

N 1/16

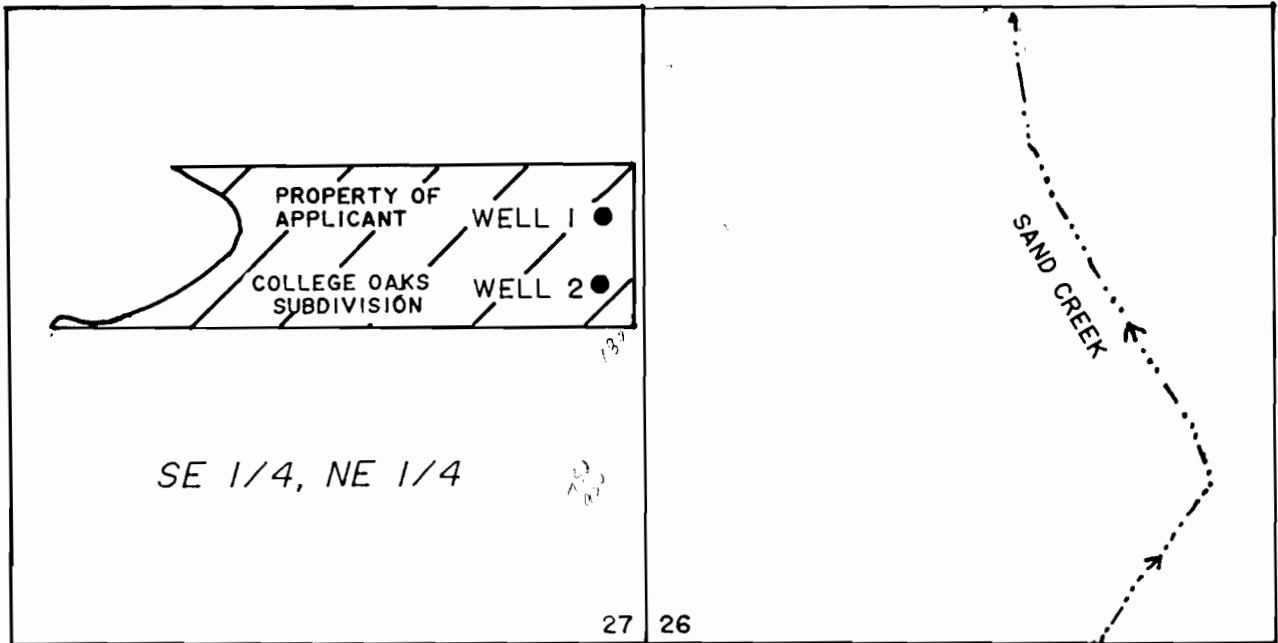

WELL 1 IS LOCATED N 4° 53' W, 888'
FROM EAST 1/4 SEC. 27. IT IS 32'
ABOVE AND 940' FROM SAND CREEK.

WELL 2 IS LOCATED N 6° 35' W, 752'
FROM EAST 1/4 SEC. 27. IT IS 36'
ABOVE AND 960' FROM SAND CREEK.

SCALE: 1" = 400'

THIS MAP IS FOR THE PURPOSE OF IDENTIFYING THE LOCATION OF THE WATER RIGHT ONLY AND IS NOT INTENDED TO PROVIDE LEGAL DIMENSIONS OR LOCATIONS OF PROPERTY OWNERSHIP LINES.

PREPARED BY:
JONATHAN C. SPERO C.W.R.E. 123
1002 KINCAID RD./P.O. BOX 16
WILLIAMS, OREGON 97544
PHONE (503) 846-6845

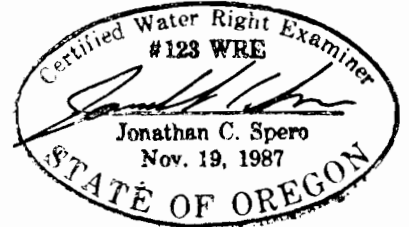

EXPIRES 06/30/96