

**T7S R48E
WILLAMETTE MERIDIAN**

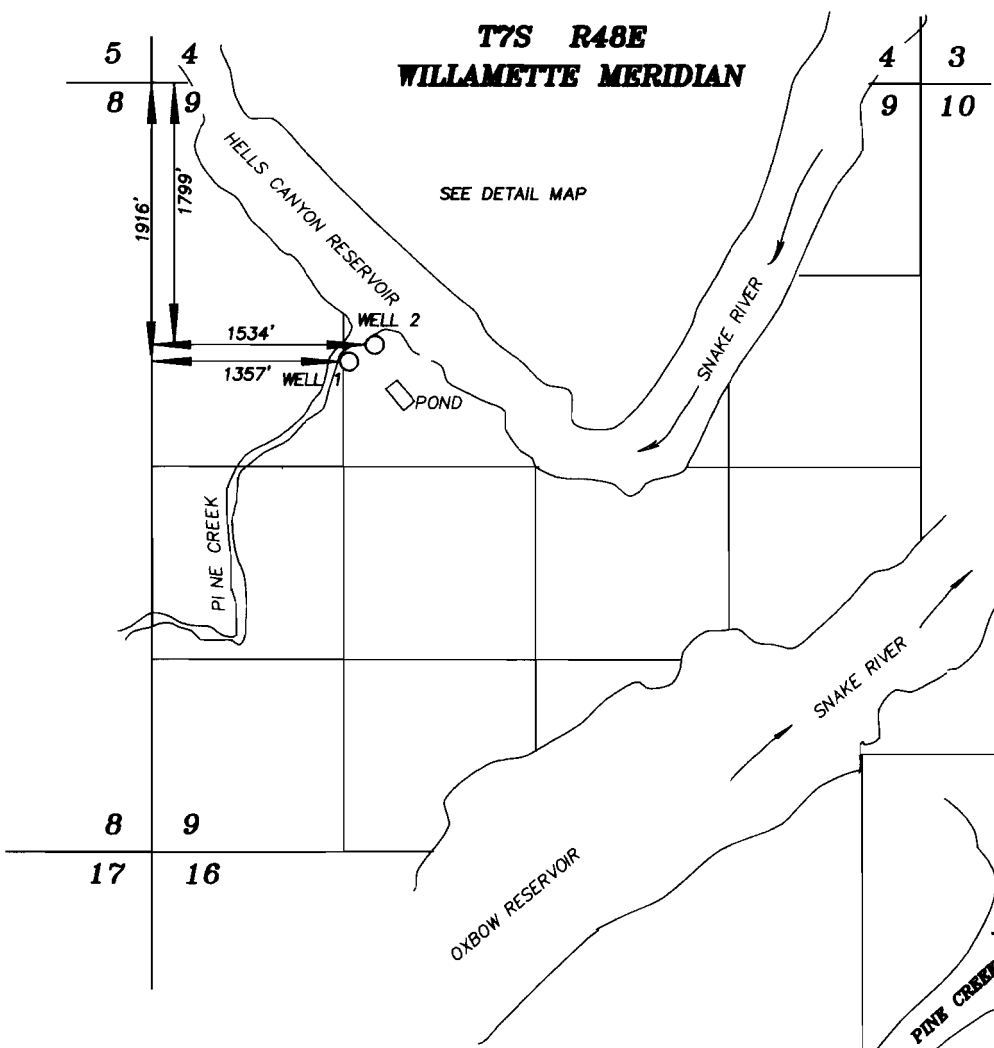

SCALE: 1"=1320'

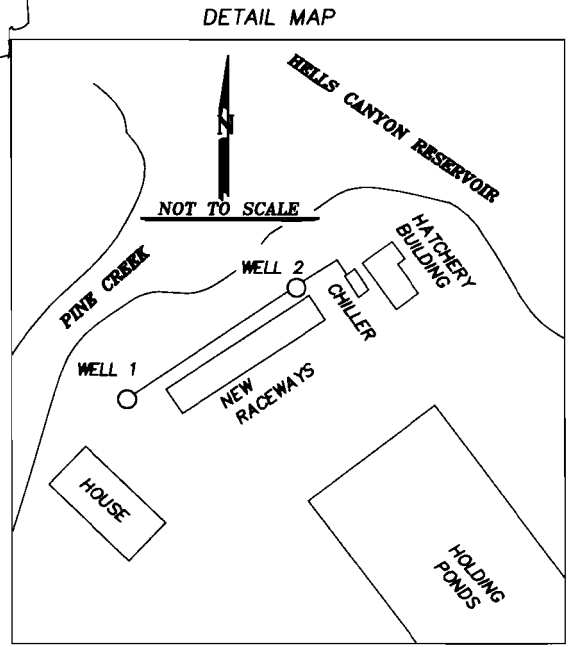

FINAL PROOF MAP OF WATER RIGHTS FROM WELL #1 AND WELL #2

FOR

IDAHO POWER COMPANY

NOVEMBER 3, 2000

BAGETT-GRIFFITH & BLACKMAN
2006 Adams Avenue
LAGRANDE OREGON 97850

APPLICATION NO. G-12886
PERMIT NO. G-12778

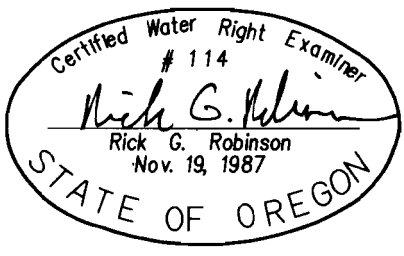

NOTE: The preparation of this map was for the purpose of identifying the location of the proposed water right and has no intent to provide dimensions or location of property ownership lines. Location information shown hereon was furnished by the applicant.

RECEIVED

NOV 21 2000