

APPLICATION MAP FOR SELMET, INC.  
INDUSTRIAL & DOMESTIC USE

LOCATED IN  
SECTION 33  
T.11 S., R.3 W., W.M.  
LINN COUNTY, OREGON  
SCALE: 1"=1320'-0"  
TAX LOT # 502

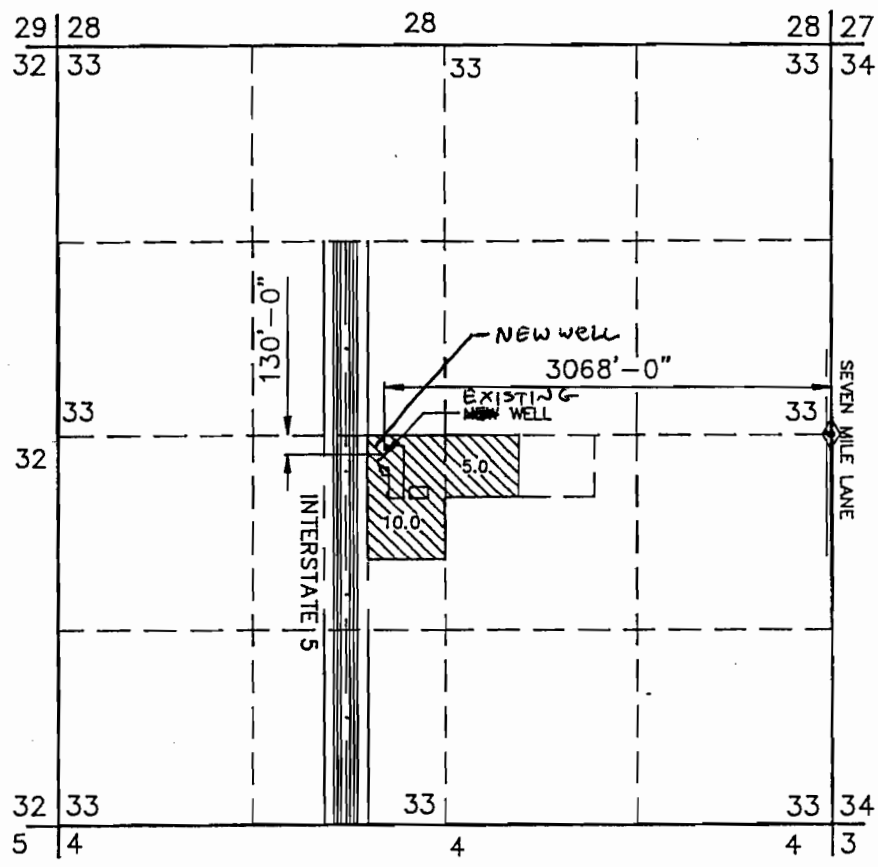
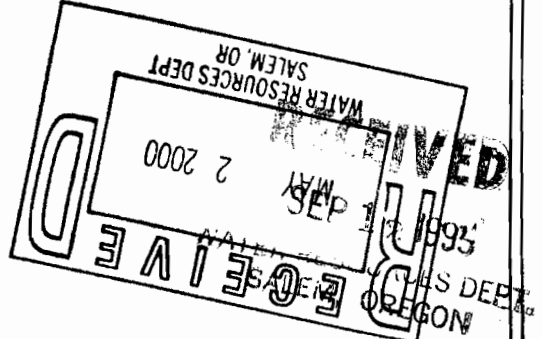

RECEIVED

OCT 16 1995  
WATER RESOURCES DEPT  
SALEM, OREGON

LEGEND:

- = SECTION LINES
- - - = FORTY LINES
- ▨ = NEW ACREAGES BEING APPLIED FOR.

ACREAGE SUMMARY

SECTION 33	NW 1/4, SE 1/4	5.0 ACRES
	NE 1/4, SW 1/4	10.0 ACRES

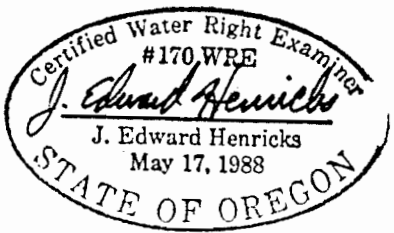

Application No. *G14182* T-8508  
Permit No. *G12811*

I J. EDWARD HENRICKS, BEING DULY SWORN AS A WATER RIGHT EXAMINER LICENSE NO. 170, HAVE PREPARED THIS MAP FOR SELMET, INC. (DALE CRONAN) ON THIS 31 st DAY OF AUGUST 1995. THE AREAS HATCHED REPRESENT THE ACREAGES TO BE IRRIGATED.

ONLY DOCUMENTS STAMPED WITH RED INK ARE ORIGINALS.

PREPARATION OF THIS MAP IS FOR THE PURPOSE OF IDENTIFYING THE LOCATION OF THE WATER RIGHT ONLY AND HAS NO INTENT TO PROVIDE DIMENSIONS OR LOCATION OF PROPERTY OWNERSHIP LINES.