

T 25 S, R 30 E, WM

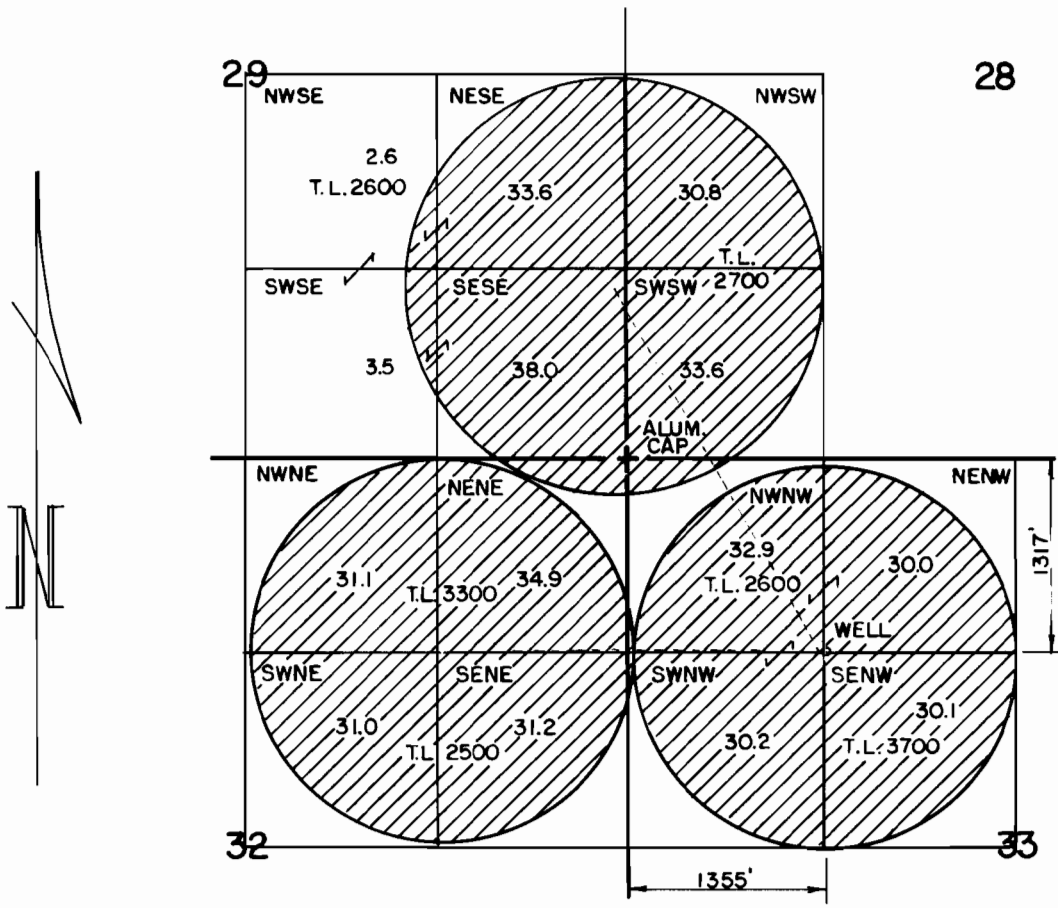

THE PURPOSE OF THIS MAP IS TO IDENTIFY THE LOCATION OF THE WATER RIGHT. IT IS NOT INTENDED TO PROVIDE INFORMATION RELATIVE TO THE LOCATION OF PROPERTY OWNERSHIP.

900

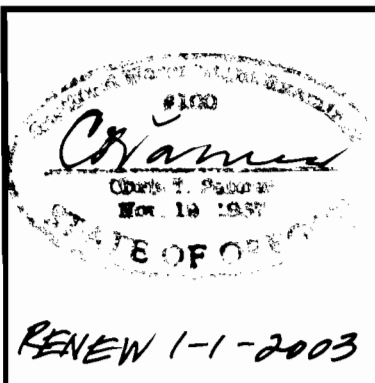

FINAL PROOF SURVEY		IN THE NAME OF DENNY LAND & CATTLE CO, LLC
UNDER APPLICATION NO. G-14136 PERMIT NO. G-12841		
Scale: 4" = 1 MILE	Date: JUNE 2001	Job: 1990
Dsn:	MAP's M.A. PALMER & SONS, INC. ENGINEERING & SURVEYING 711 Ponderosa Village • Box 61 Burns, Oregon 97720	Sht. No.
Drm: CHRIS		
Ckd:		of 1