

RECEIVED

OCT 14 1995

WATER RESOURCES DEPT.
SALEM, OREGON

T 3 S R 38 E T 3 S R 39 E



SCALE 1" = 1320'

NOTE: The NW 1/4 of the SW 1/4 and the NE 1/4 of the SW 1/4 of Section 7 is owned by Etta Lucinda Delashmutt.

The East 1/2 of the SE 1/4 of Section 12 is owned by William A. Delashmutt.

The SW 1/4 of the NW 1/4 of Section 7 is owned by Eva Fern Bay.

The SE 1/4 of the NW 1/4 of Section 7 is owned by William R. Delashmutt & Etta Delashmutt.

The West 1/2 of the SE 1/4 of Section 12 is owned by Donald T. McCabe.

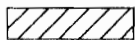
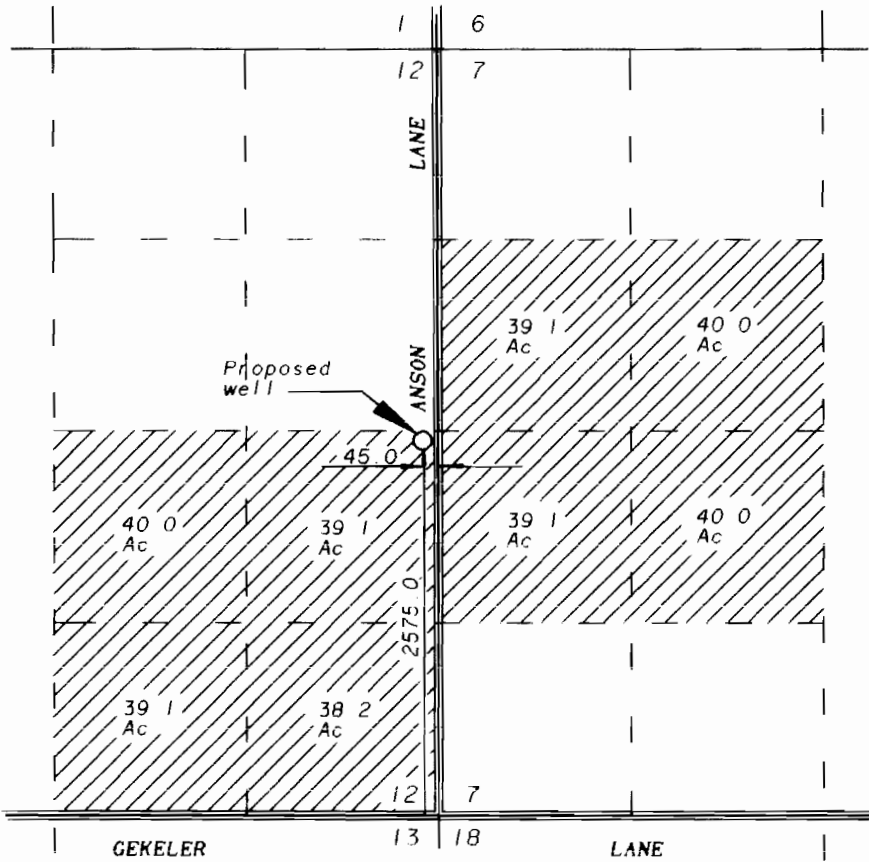

Lands requesting Primary water from well.

APPLICATION FOR WATER RIGHTS

FOR

**Don McCabe, Eva Fern Bay
William R. & William A. Delashmutt
Etta Lou Delashmutt**

BY

**BAGETT - GRIFFITH & BLACKMAN
2006 ADAMS AVENUE
LAGRANDE, OREGON 97850**

OCTOBER 2, 1995

APPLICATION NO 6-14205

PERMIT NUMBER 615951

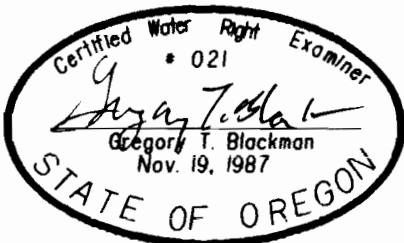

NOTE: The preparation of this map was for the purpose of identifying the location of the proposed water right and has no intent to provide dimensions or location of property ownership lines. Location information shown hereon was furnished by the applicant.