

T.7S., R.1W., W.M.

RECEIVED

APR 28 1995

WATER RESOURCES DEPT.
SALEM, OREGON

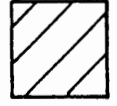
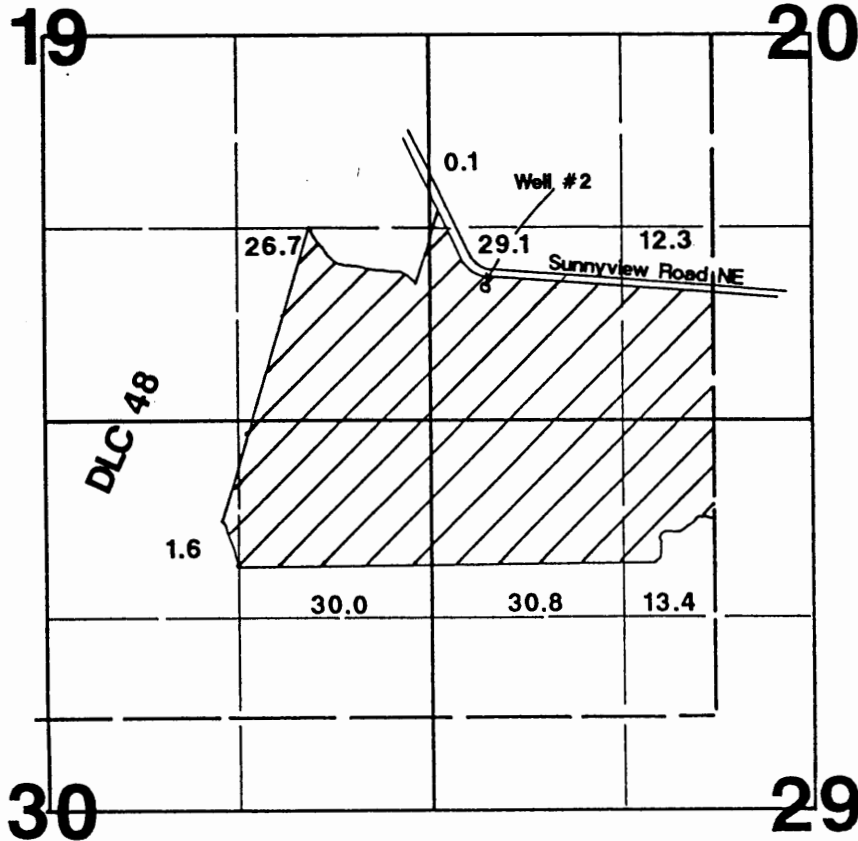

Area Irrigated

Well located 900'N & 390'E from SW corner Section 20.



Application Map

Richard Kuenzi

Application #: G-14053 Permit #: G-12957

THIS MAP WAS PREPARED FOR THE PURPOSE OF IDENTIFYING THE LOCATION OF A WATER RIGHT ONLY AND IS NOT INTENDED TO PROVIDE LEGAL DIMENSIONS OR LOCATION OF PROPERTY OWNERSHIP LINES.