

# T.6S., R.3W., W.M.

RECEIVED

FEB 21 1996

WATER RESOURCES DEPT  
SALEM, OREGON

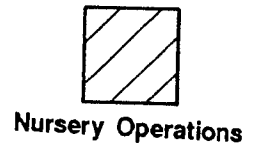
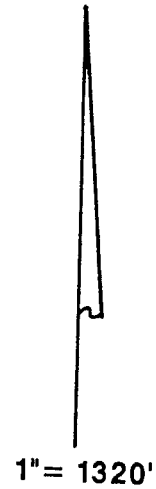
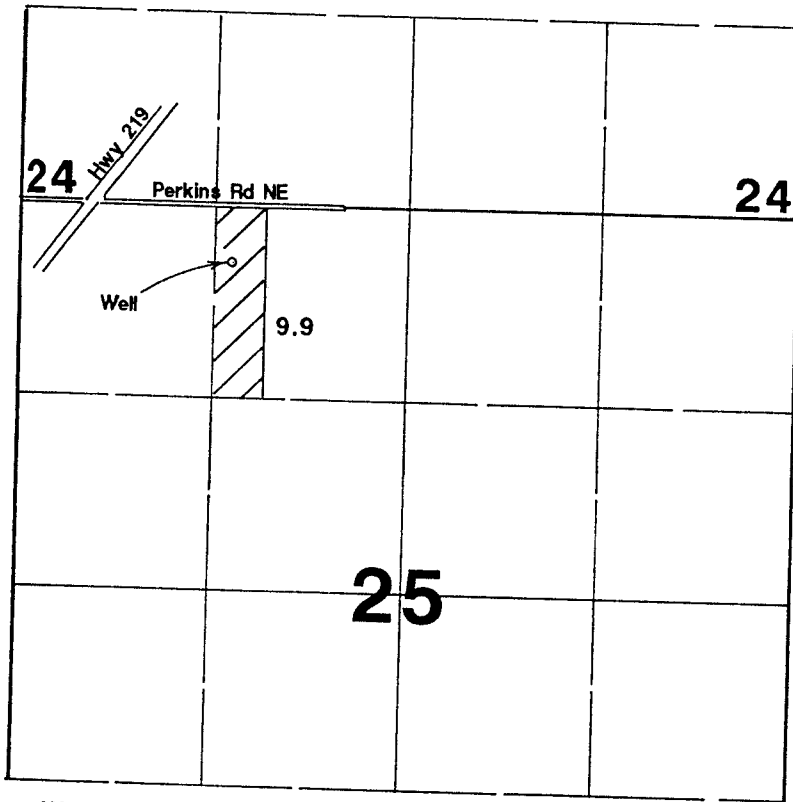

Well located 420'S & 1500'E from SW corner Section 24.

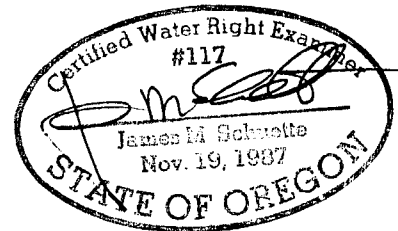

Application Map

## Harold Tennant

Application #: 6714256 Permit #: 612969

THIS MAP WAS PREPARED FOR THE PURPOSE OF IDENTIFYING THE LOCATION OF A WATER RIGHT ONLY AND IS NOT INTENDED TO PROVIDE LEGAL DIMENSIONS OR LOCATION OF PROPERTY OWNERSHIP LINES.