

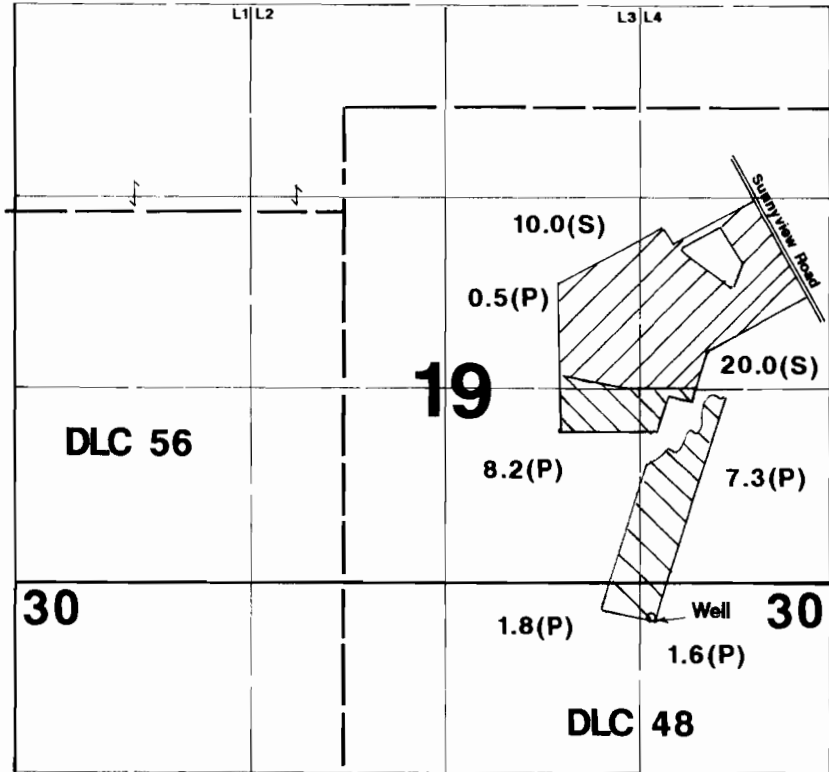



# T.7S., R.1W., W.M.



1" = 1320

-  Supplemental
-  Primary
-  Area Irrigated

Well is located 235'S & 1235'W from the NE corner of Section 30.

## Final Proof Survey

In Name Of

# Kenneth L. Ogren

Application #: G-14242

Permit #: G-12982

Surveyed on May 13, 2003 by JM Schuette

This Map Was Prepared For The Purpose Of Identifying The Location Of A Water Right Only And Is Not Intended To Provide Legal Dimensions Or Location Of Property Ownership Lines.

