

MHK 1 of 2

LINN

RECEIVED

SEP - 9 1996

WATER RESOURCES DEPT.
SALEM, OREGON

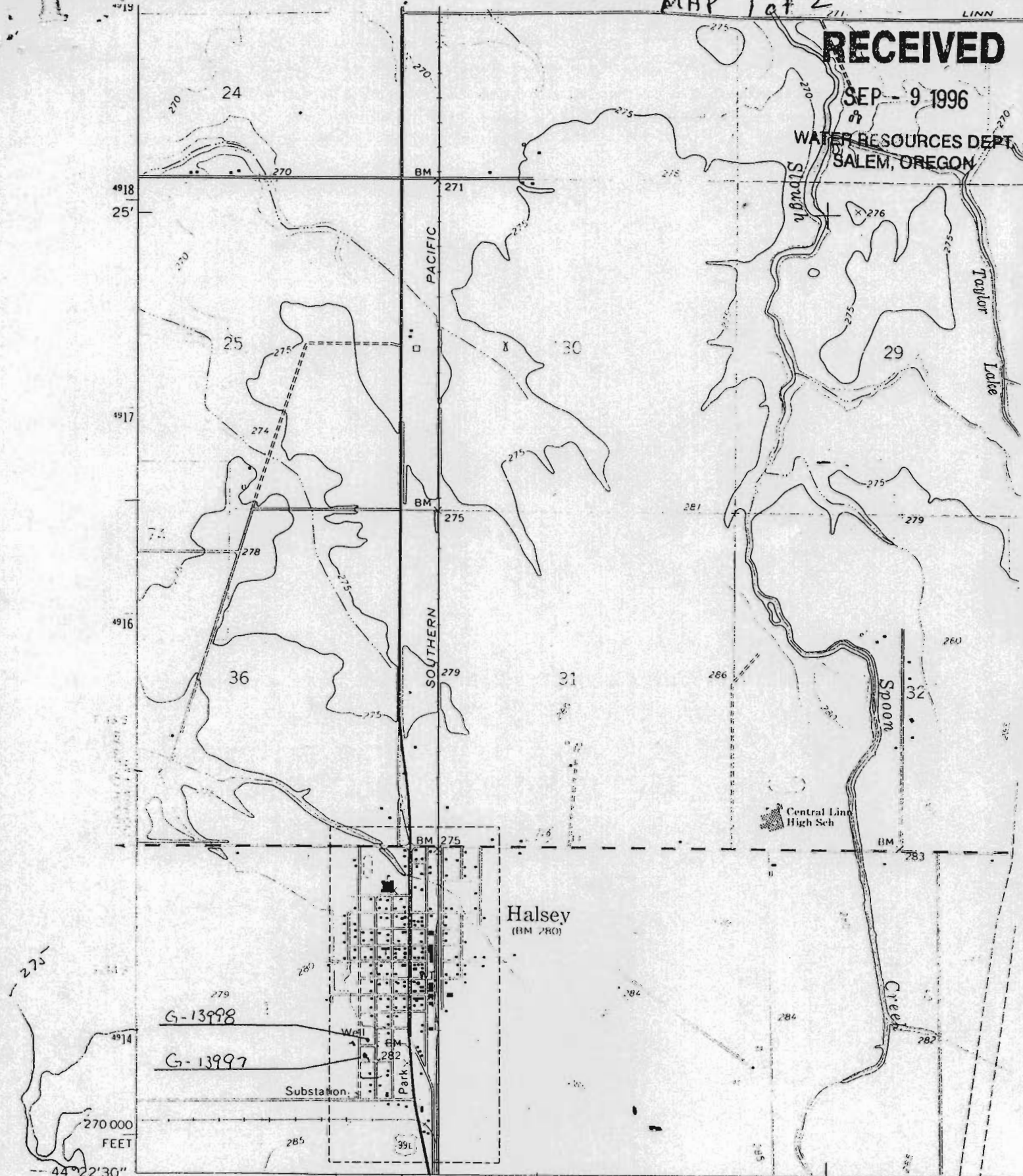

(HARRISBURG)
1372 (SW)

Mapped, edited, and published by the Geological Survey
Control by USGS, USC&GS, and State of Oregon
Topography by photogrammetric methods from aerial
photographs taken 1967. Field checked 1969
Polyconic projection. 1927 North American datum
10,000-foot grid based on Oregon coordinate system,
north zone
1000-meter Universal Transverse Mercator grid ticks

APPLICATION: G-13997
* PERMIT: G12997

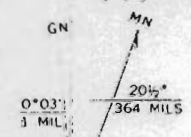

1 320 000 FEET R 3 493 5' 494

17 4 W 11

HALSE

EDMONDS INDUSTRIAL TRACTS

1" = 100'

200

See Map 14 4 IAD

S.N. Co. Bk. 32

PARCEL I
13773

3600
391A

C.S. 20477

PARTITION PLAT NO. 1992-40

G-13998

G-13997

APPLICATION: G-13997
PERMIT: G12997

MAP 2 of 2

RECEIVED

SEP - 9 1996

WATER RESOURCES DEPT.
SALEM, OREGON

See Map 14 3W 6

4000 SUBSURFACE

E 1/4 CORN

5 E. Co. Bk. 10
S. 2, 3, 4, 5, 6, 7, 8, 9, 10, 11, 12, 13, 14, 15, 16, 17, 18, 19, 20

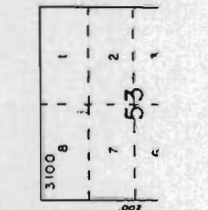
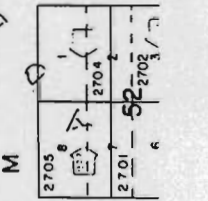
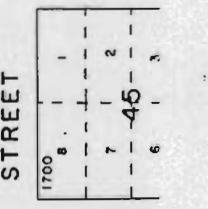
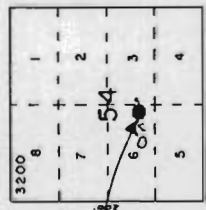
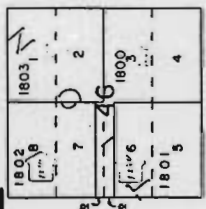
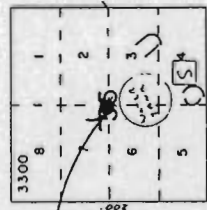
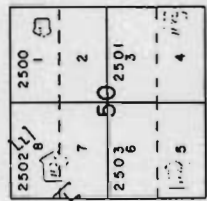
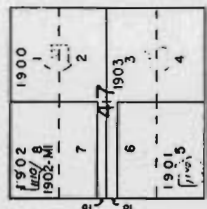
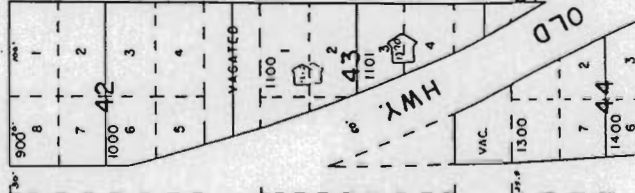
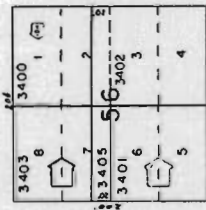
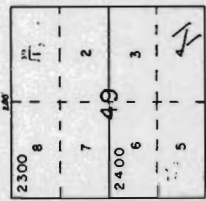
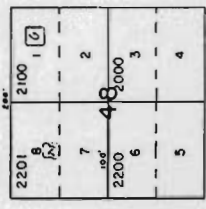

17 4 W 11