

# T.4S. R.1E. W.M.

CLACKAMAS COUNTY

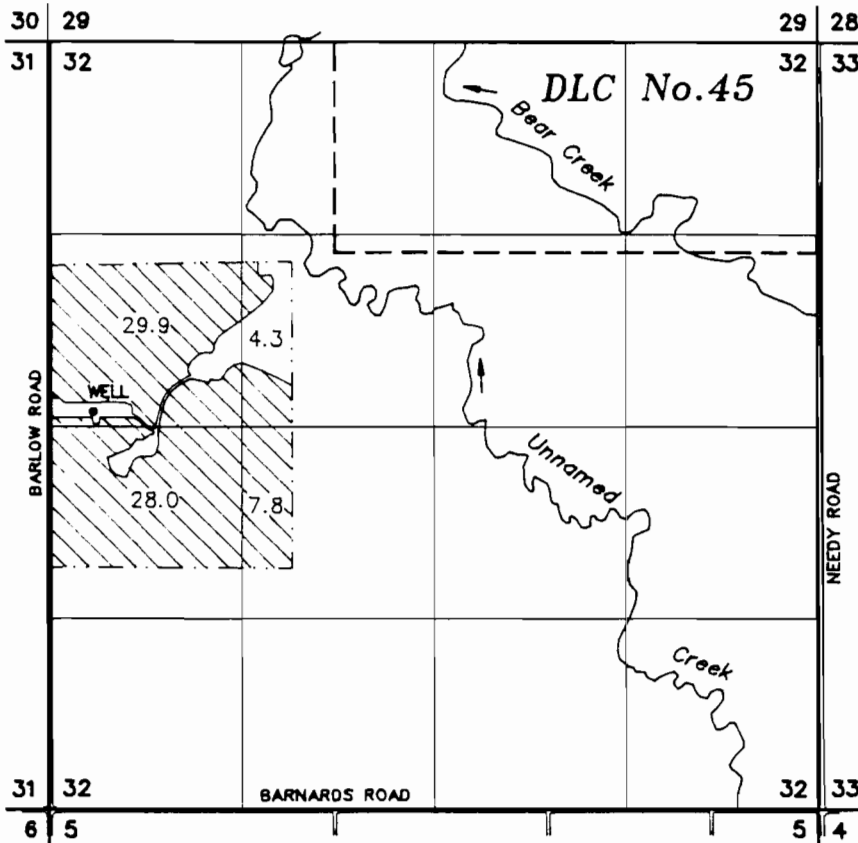

DIVERSION POINT: 2800' N AND 250' E OF THE SW CORNER OF SECTION 32.

## FINAL PROOF SURVEY

UNDER

Application No. G-13951

Permit No. G-13012

GARY R. POSTLEWAIT

SEPTEMBER 7, 1999

SCALE: 1" = 1320'

NOTE: This map is for the purpose of identifying the location of water rights and has no intent to dimension or locate property ownership lines.

