

# T.7S., R.2W., W.M

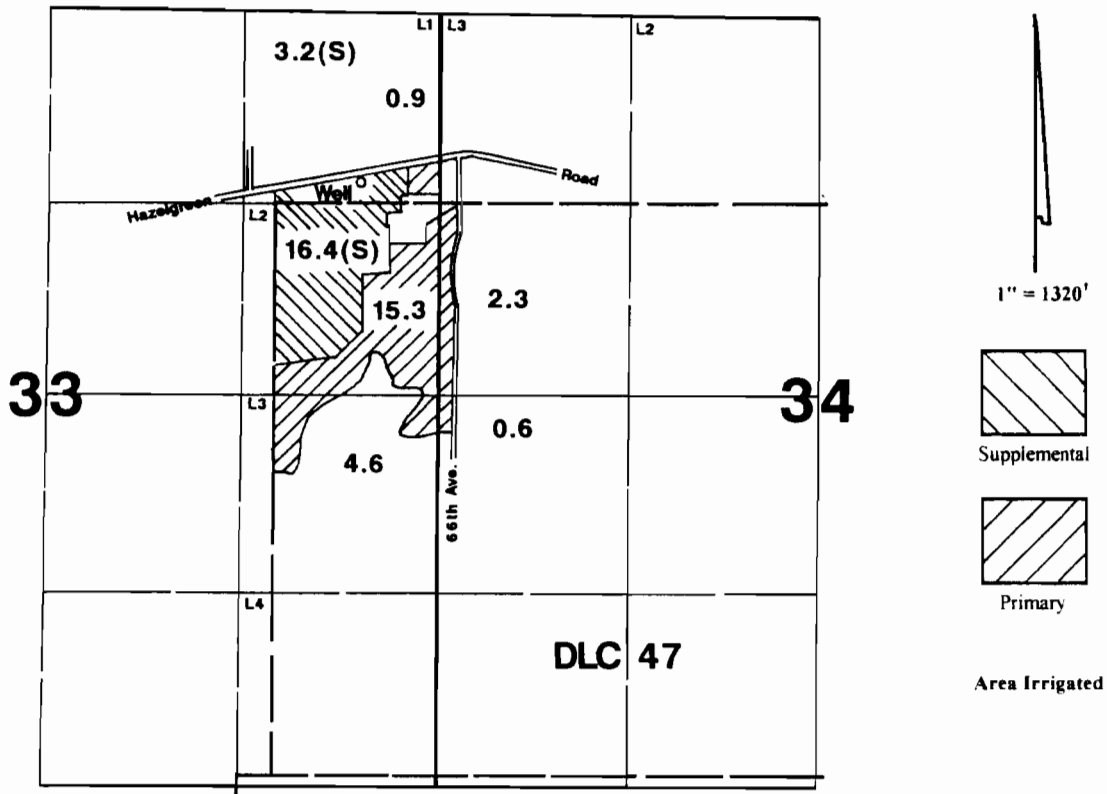

Well is located 1160'S & 520'W from the NE corner of Section 33.

## Final Proof Survey

In Name Of

### Vincent Woods & E.H. Woods

Application #: G-13688

Permit #: G-13041

Surveyed on September 26, 2000 by JM Schuette

This Map Was Prepared For The Purpose Of Identifying The Location Of A Water Right Only And Is Not Intended To Provide Legal Dimensions Or Location Of Property Ownership Lines

