

RECEIVED

JUN 17 1998

T. 7 & 8 S., R. 3 W. W.M.

WATER RESOURCES DEPT
SALEM OREGON

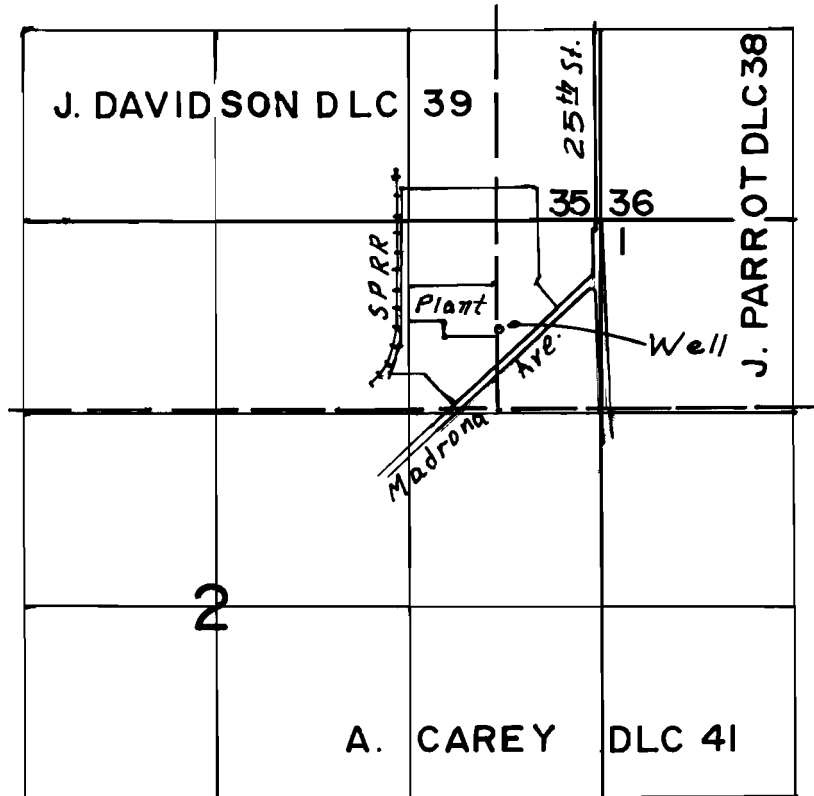

Scale
4" = 1 Mi.

Well loc. 560' N & 10' E from SW Cor. DLC 38

FINAL PROOF SURVEY
UNDER

Application No. G-19235 Permit No. G-13062...

IN NAME OF

NORPAC FOODS, INC.

Surveyed June 2, 1978, by

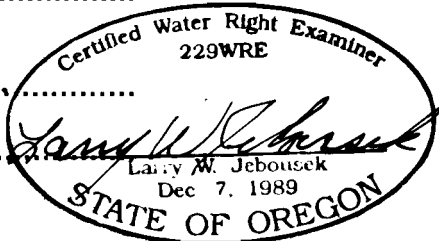

THIS MAP WAS PREPARED FOR THE PURPOSE OF IDENTIFYING THE LOCATION OF A WATER RIGHT ONLY AND IS NOT INTENDED TO PROVIDE LEGAL DIMENSIONS OR LOCATION OF PROPERTY OWNERSHIP LINES.