

FINAL PROOF SURVEY

T 5 S R 2 E WM.

Portions of SECTIONS 4 & 9

application # G-14190 permit # G-13076

For: Charles L. Affolter

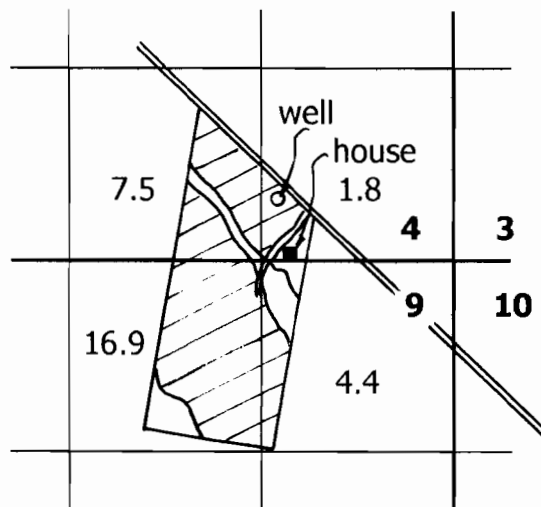

DLC 45

diversion point location: N 69 45' W, 1225' from the SE corner section 4

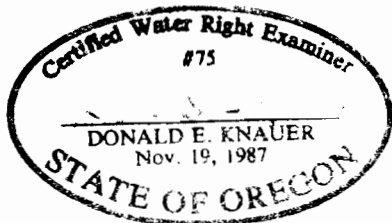

Scale 1" = 1320'

This map is to be used for water right purposes only.

Don Knauer Consulting
PO Box 5416
Salem, OR 97304
503-585-8474