

RECEIVED

JUL 08 1992

T 16 S. R 43 E, W.M.

WATER RESOURCES DEP  
SALEM, OREGON

Plan No. G-13026  
No. G13116

This map was prepared for the sole purpose of supporting a Ground Water Application by

Joseph L. Arriola  
2506 12th Ave. East  
Vale, OR 97918

for a permit for appropriation of ground water by means of five wells for supplemental irrigation.

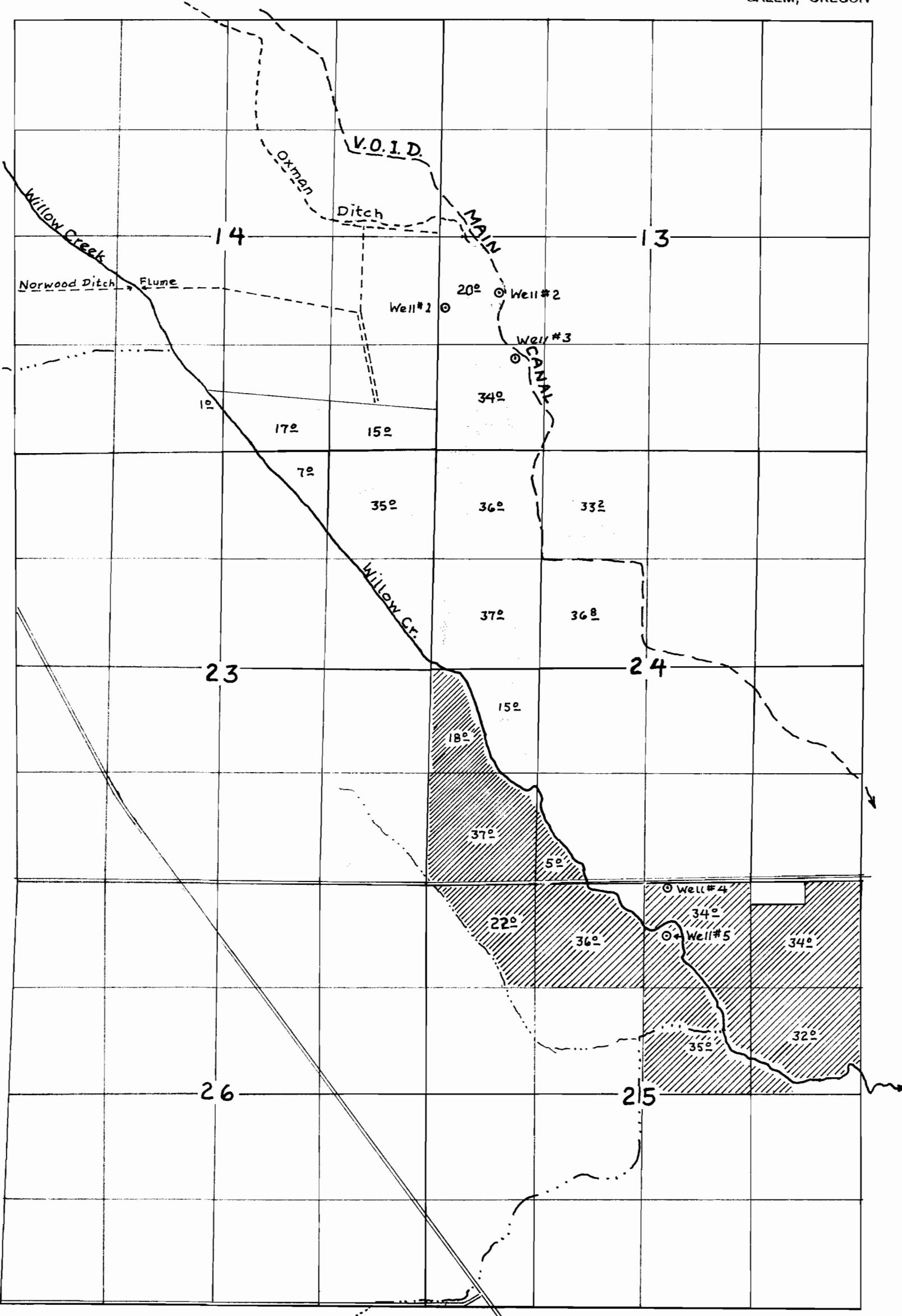
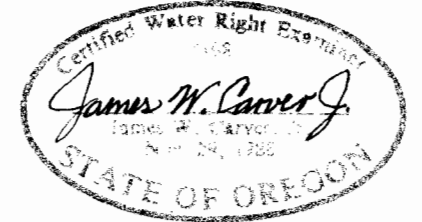

Well Locations

Well #1 1740 ft N & 20 ft E from the SW Corner of Sec. 13.

Well #2 1950 ft N & 850 ft E from the SW Corner of Sec. 13

Well #3 1140 ft N & 980 ft E from the SW Corner of Sec. 13

Well #4 20 ft S & 270 ft E from the N Quarter-Corner of Sec. 25

Well #5 600 ft S & 270 ft E from the N Quarter-Corner of Sec. 25

The lands to receive water from Wells Nos. 1, 2 & 3 are designated:

The lands to receive water from Wells Nos. 4 & 5 are designated:

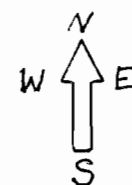

Scale: 4 inches = 1 mile