

T. 4 S. R. 1 E. W.M.

RECEIVED

MAR 29 1996

WATER RESOURCES DEPT.
SALEM, OREGON

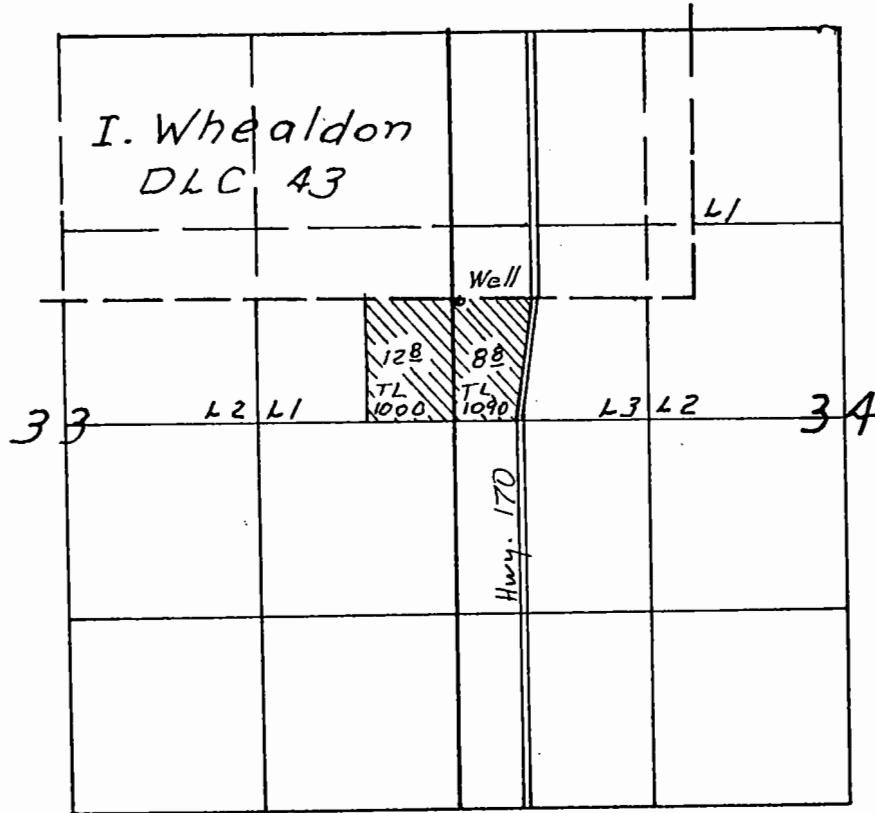

Well loc. 800' N & 30' E from W 1/4 Cor. Sec 34

Application No. G-14280
Permit No. G13129

WATER RIGHT MAP FOR
Johnathan Yu

THIS MAP WAS PREPARED FOR THE
PURPOSE OF IDENTIFYING THE LOCA-
TION OF A WATER RIGHT ONLY AND IS
NOT INTENDED TO PROVIDE LEGAL
DIMENSIONS OR LOCATION OF PROPER-
TY OWNERSHIP LINES.

