

T. 7 S., R. 39 E., W.M.

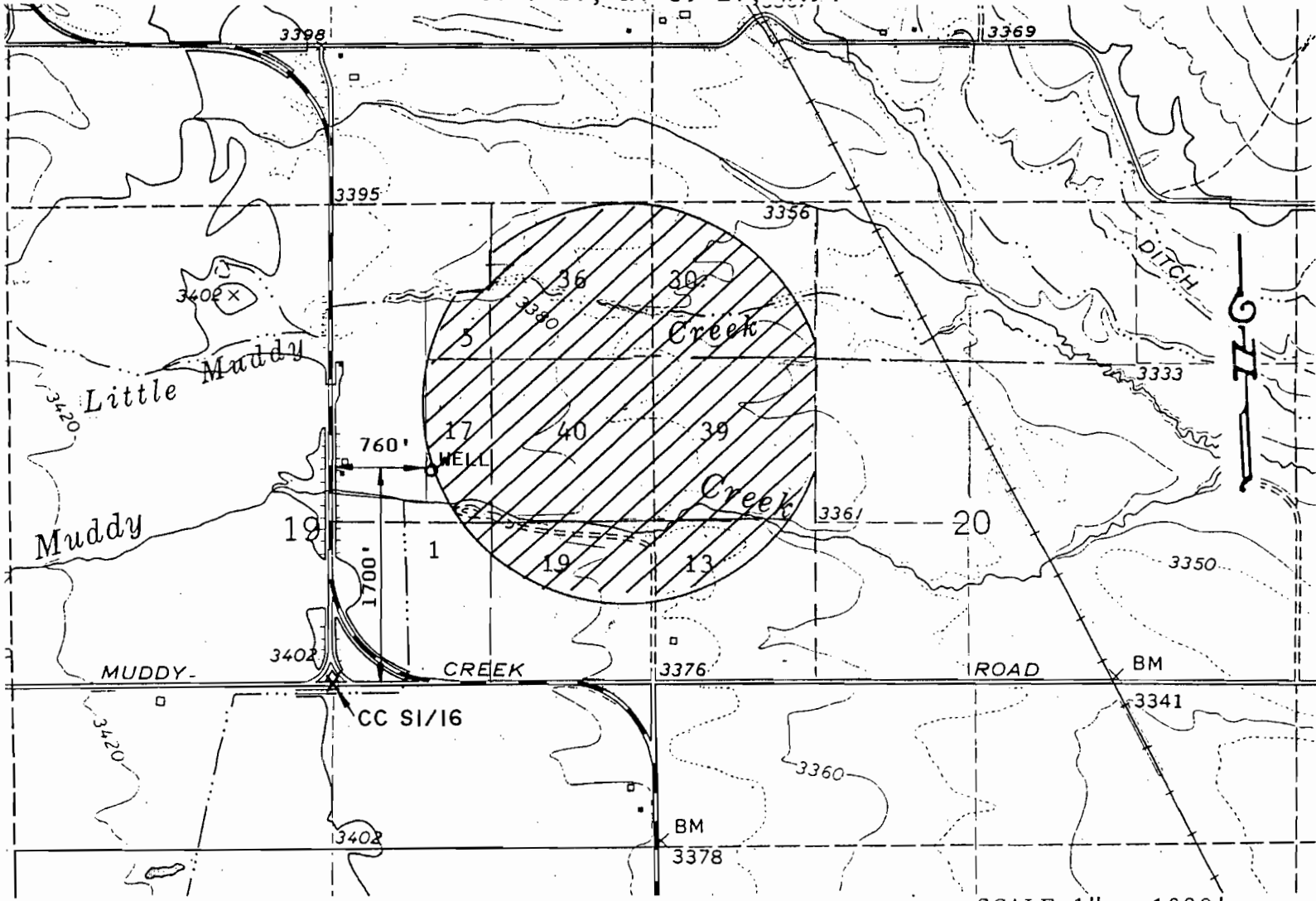

SCALE 1" = 1320'

MAP TO ACCOMPANY APPLICATION FOR PERMIT
TO APPROPRIATE WATER FOR IRRIGATION

RECEIVED

JAN - 6 1997

WATER RESOURCES DEPT.
SALEM, OREGON

Application No. G114276

Permit No. G13134

Applicant: Gary Kramer
Tel. 541-898-2303

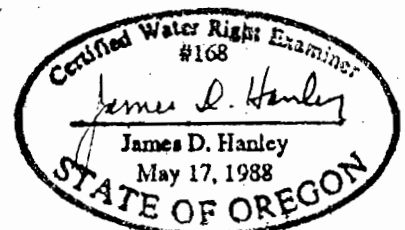

~~Note: The exact location of proposed well is not determined at this time. It will be drilled on his own property. No easements are required.~~

JANUARY, 1996
Rev. Dec., 1996