

T. 8S, R. 38E

T. 8S), .6 R 39E

Application No. 3790  
Permit No. 01158

RECEIVED

AUG 12 1994

WATER RESOURCES DEPT.  
SALEM, OREGON

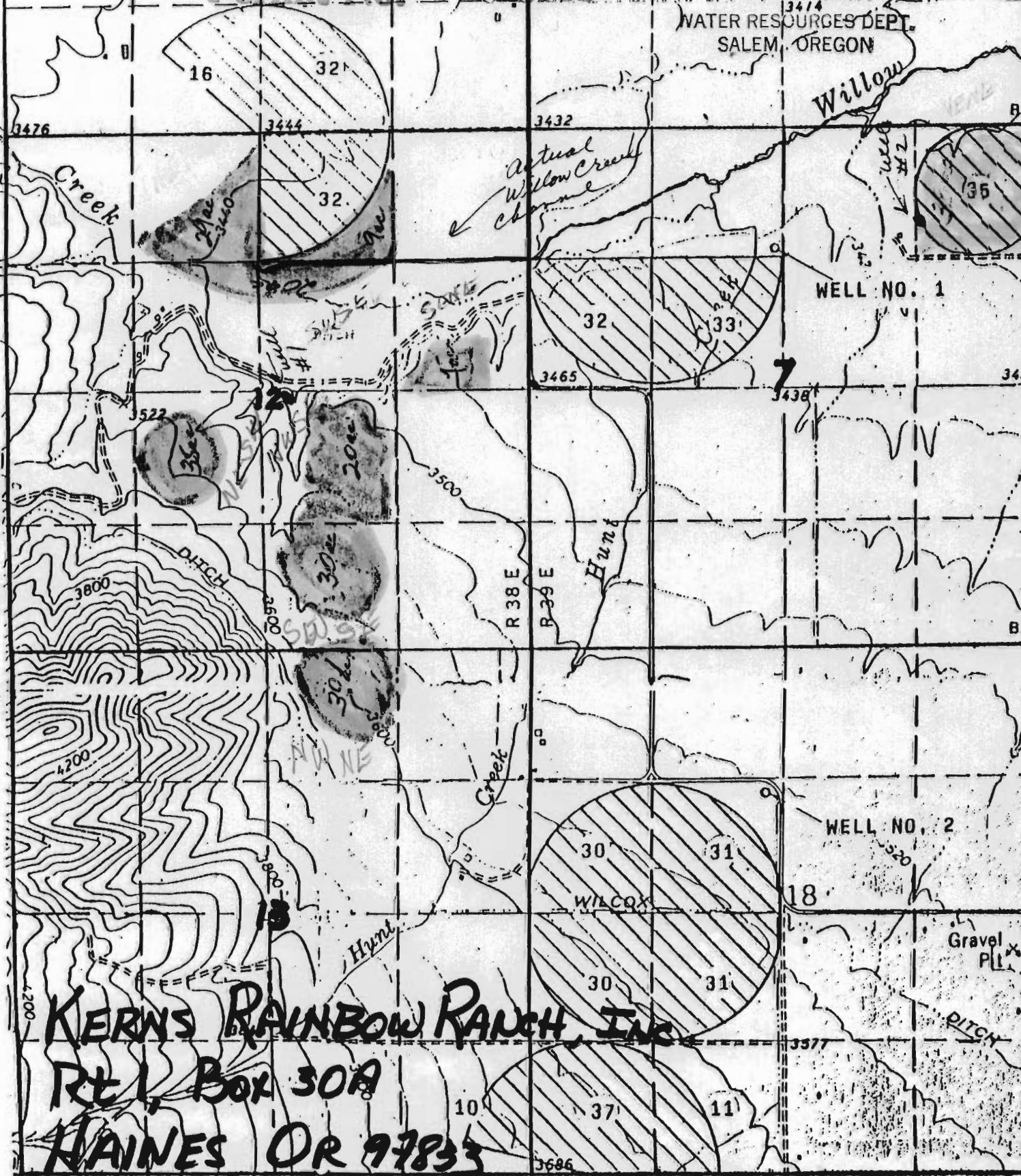

KERN'S RAINBOW RANCH, INC.  
RE 1, Box 30A  
HAINES, OR 97833

SCALE 1" = 1320'

MAP TO ACCOMPANY