

TOWNSHIP 15 SOUTH, RANGE 4 WEST, W.M.

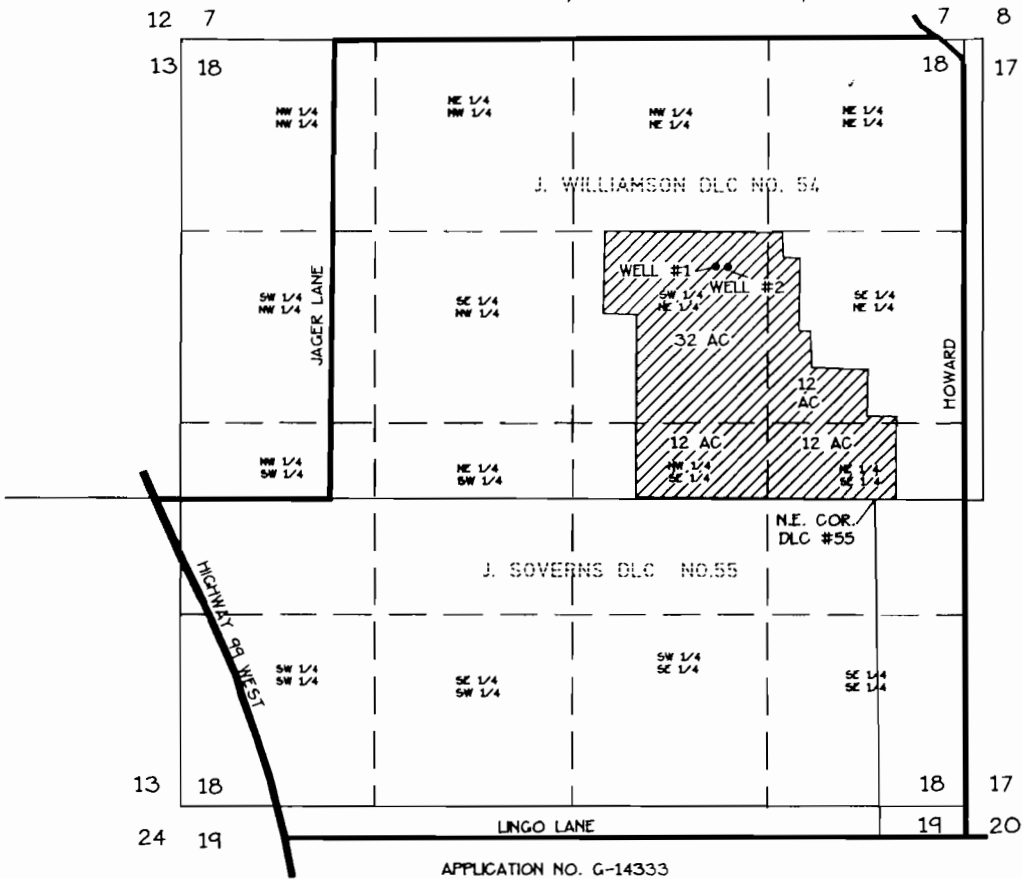

APPLICATION NO. G-14333
 PERMIT NO. G-13161

WELL LOCATION:

- WELL #1 - NORTH 1600 FEET + 1094 FEET
 WEST OF THE N.E. COR. DLC #55
- WELL #2 - NORTH 1600 FEET + 1069 FEET
 WEST OF THE N.E. COR. DLC #55

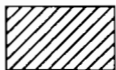

DENOTES AREA OF BENEFICIAL USE

NOTE:

THIS MAP WAS PREPARED FOR THE PURPOSE OF IDENTIFYING THE LOCATION OF THE WATER RIGHT ONLY. IT IS NOT INTENDED TO PROVIDE DIMENSIONS OR LOCATION OF PROPERTY OWNERSHIP LINES.

OCTOBER 14, 1997
 JOB NO. 1G18.04
 DWG NO. JC1G184F.DWC

FINAL PROOF SURVEY
 FOR
GORDON AND SONI JAGER
 AND
CLINT AND DILLON JAGER
 28645 JAGER LANE
 JUNCTION CITY, OREGON 97448
 (541)938-1902
 BY
FORD-NESS-FASSBENDER
 PO BOX 22735
 EUGENE, OR 97402
 (541)344-1852

