

T.6S., R.1W., W.M.

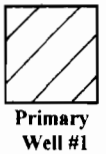
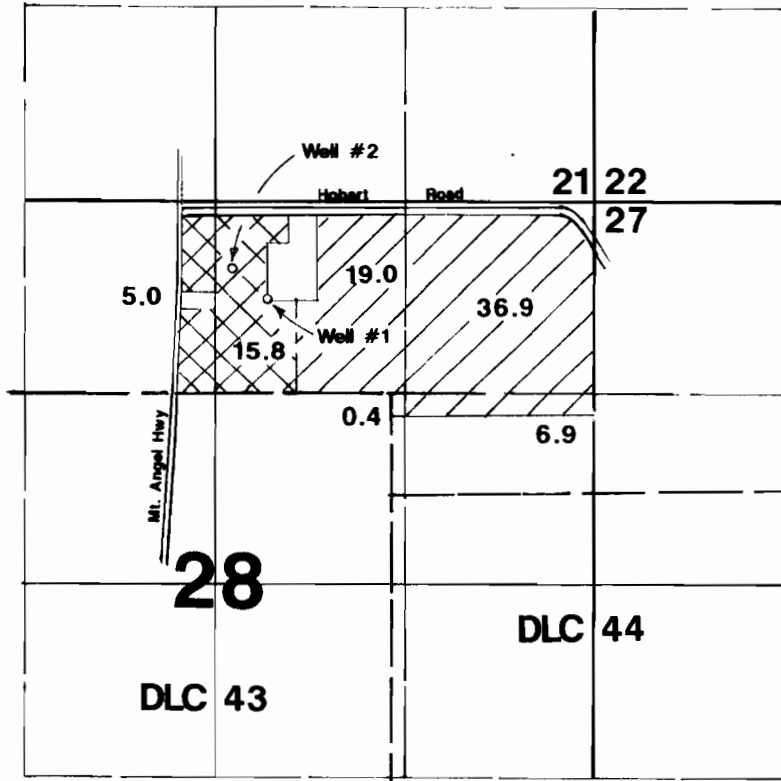

Area Irrigated

Well #1 is located 660'S & 350'E from the N1/4 corner of Section 28.
Well #2 is located 462'S & 462'E from the N1/4 corner of Section 28.

Final Proof Survey

In Name Of

Hynes Farms

Application #: G-13676

Permit #: G-13186

Surveyed on January 18, 2003 by JM Schuette

This Map Was Prepared For The Purpose Of Identifying The Location Of A Water Right Only And Is Not Intended To Provide Legal Dimensions Or Location Of Property Ownership Lines.

