

APPLICATION MAP

IN THE NAME OF RICHARD HALLIBURTON

SECTION 3, T 28 S, R 14 W, W.M.

NOV 18 1935

WATER RIGHT APPLICATION

No. G 14411
01922K

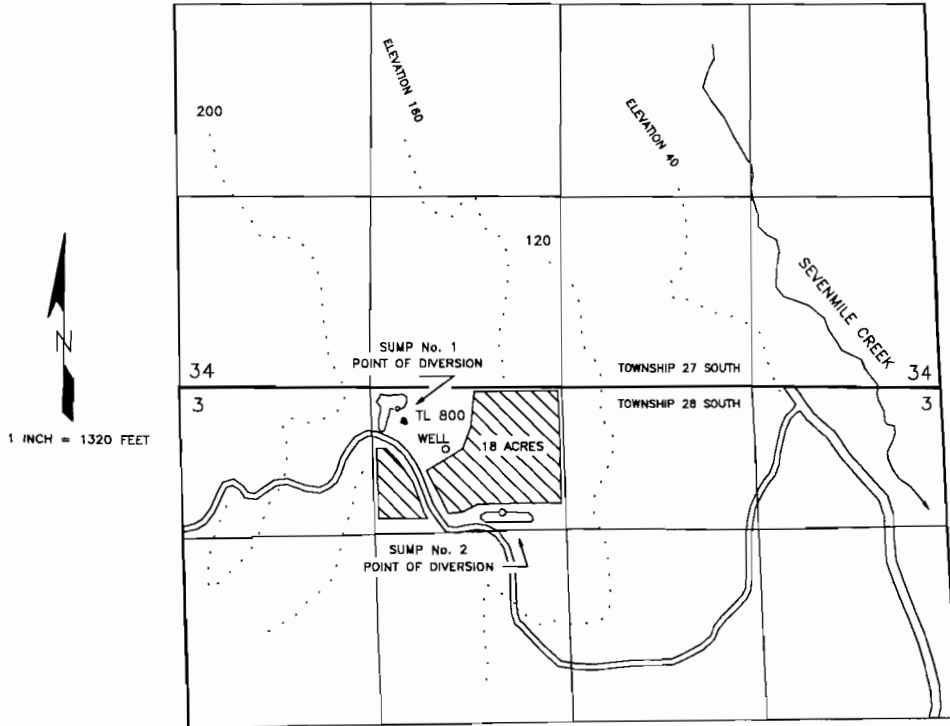

THE POINTS OF DIVERSION ARE TO BE LOCATED AS FOLLOWS:

SOURCE	SOUTH	WEST	¼ ¼ SECTION	SECTION
SUMP No. 1	149 FEET	1,120 FEET	NE¼NW¼	3
SUMP No. 2	870 FEET	400 FEET	NE¼NW¼	3
DRILLED WELL	430 FEET	800 FEET	NE¼NW¼	3

ALL FROM THE NORTH QUARTER CORNER OF SECTION 3, BEING WITHIN THE NE¼NW¼ OF SECTION 3, TOWNSHIP 28 SOUTH, RANGE 14 WEST, W.M., COOS COUNTY.

THE PURPOSE OF THIS MAP IS TO IDENTIFY THE LOCATION OF THE WATER RIGHT. IT IS NOT INTENDED TO PROVIDE INFORMATION RELATIVE TO THE LOCATION OF PROPERTY OWNERSHIP BOUNDARY LINES.