

RECEIVED

MAY 20 1997

WATER RESOURCES DEPT.
SALEM, OREGON

T.5S., R.4W., W.M.

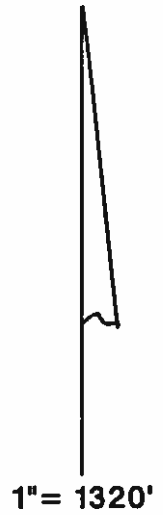
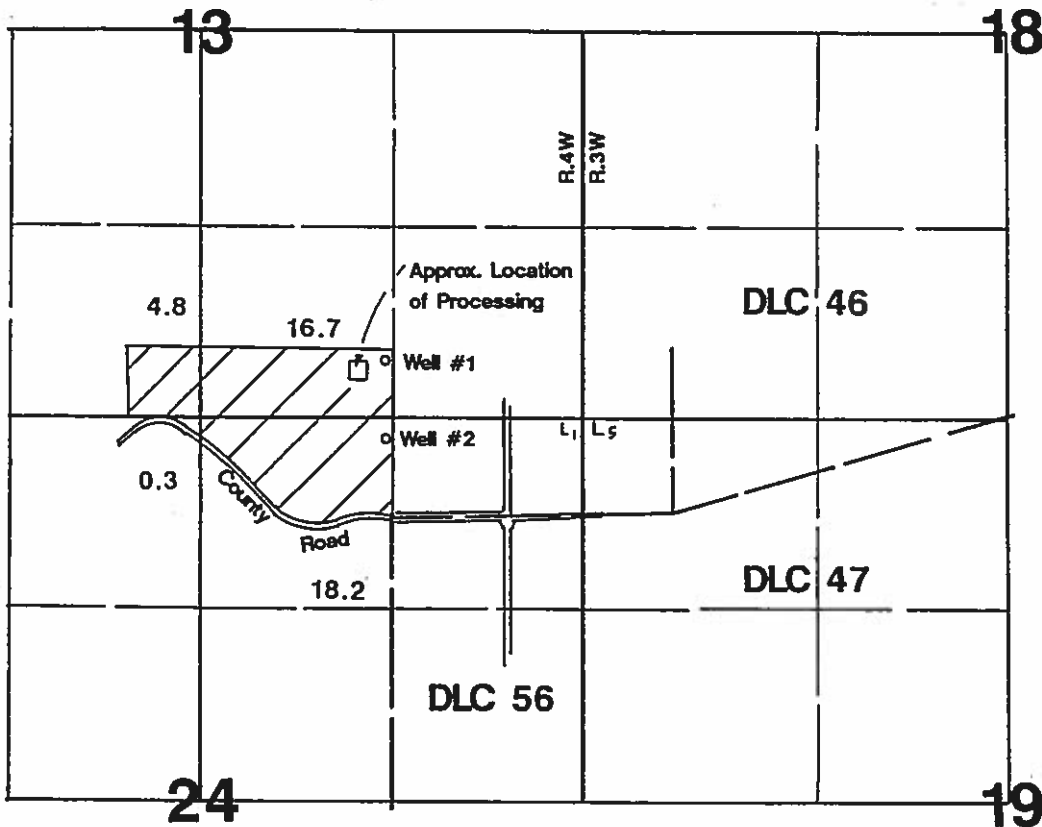

Well #1 located 1100'N & 50'W from NW corner DLC 56.
Well #2 located 550'N & 50' W from NW corner DLC 56.

Application Map

John & Katherine Zelko

Application #: 6-14354 Permit #: G13251

THIS MAP WAS PREPARED FOR THE PURPOSE OF IDENTIFYING THE LOCATION OF A WATER RIGHT ONLY AND IS NOT INTENDED TO PROVIDE LEGAL DIMENSIONS OR LOCATION OF PROPERTY OWNERSHIP LINES.

