

T.3S. & T.4S., R.2W, W.M

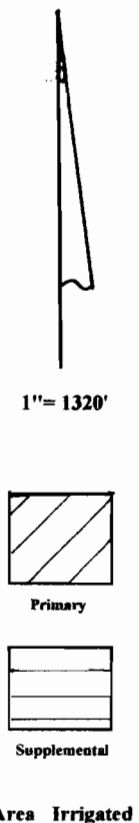
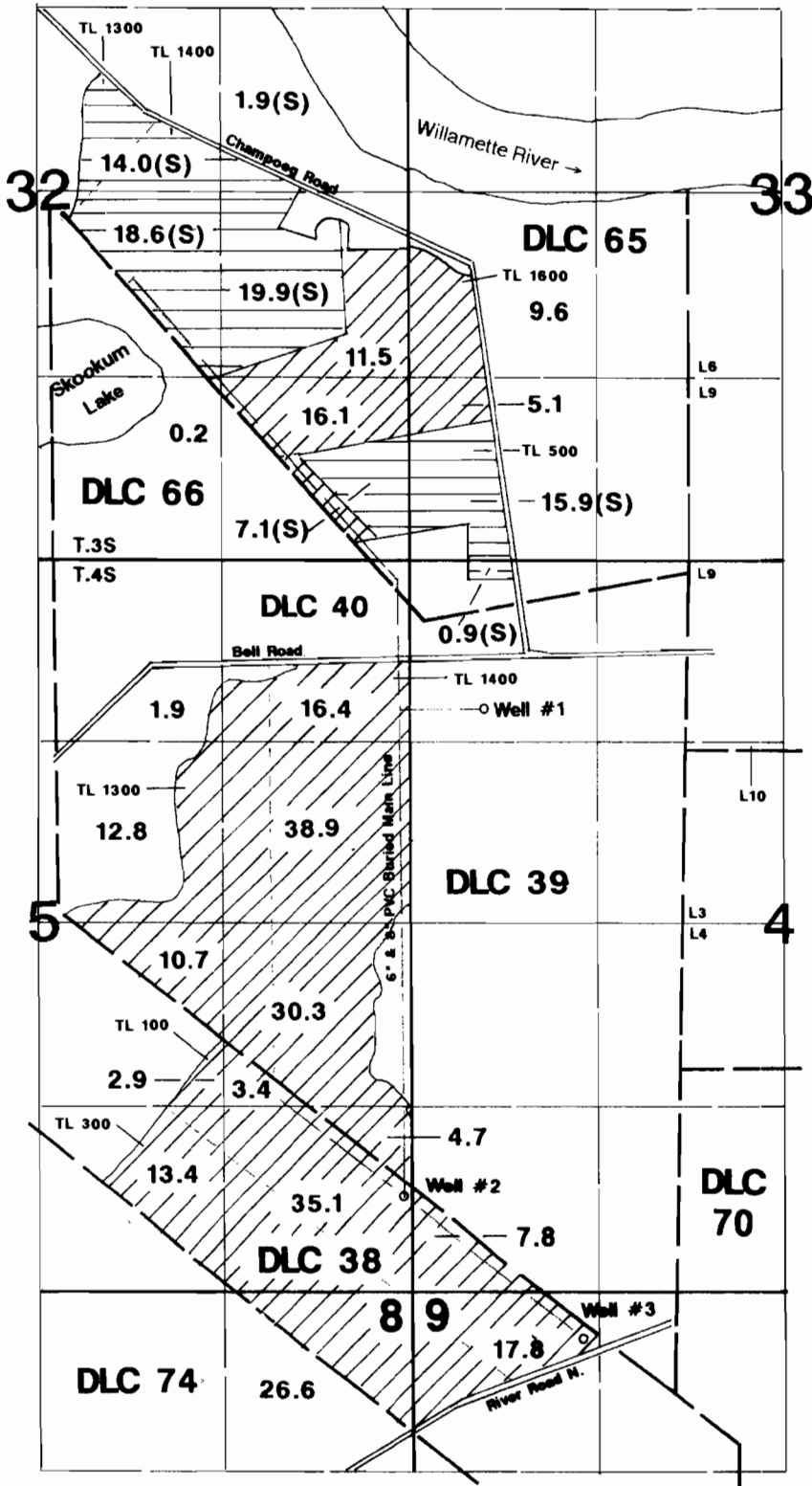

Final Proof Survey

Application #: G-14437

Permit #: G-13343

In Name Of

Hazenburg Dairy

Surveyed on August 30, 2003 by JM Schuette

Well #1 is located 1070'S & 520'E from the NW corner of Section 4.
 Well #2 is located 660'N & 50'W from the SE corner of Section 5.
 Well #3 is located 330'S & 1220'E from the NW corner of Section 9.

This Map Was Prepared For The Purpose Of Identifying The Location Of A Water Right Only And Is Not Intended To Provide Legal Dimensions Or Location Of Property Ownership Lines.