

RECEIVED

NOV 14 1991
WATER RESOURCES DEPT
SALEM, OREGON



SCALE 1" = 1320'

NOTE: PREPARATION OF THIS MAP IS FOR IDENTIFYING PROPOSED WATER RIGHTS ONLY. IT HAS NO INTENT TO PROVIDE LOCATIONS OR DIMENSIONS OF PROPERTY BOUNDARIES.

MAP TO ACCOMPANY APPLICATION FOR TRANSFER OF WATER RIGHT AND PERMIT TO APPROPRIATE GROUND WATER T14S, R12E

APPLICATION NO. G-11923
PERMIT NO. G-13362

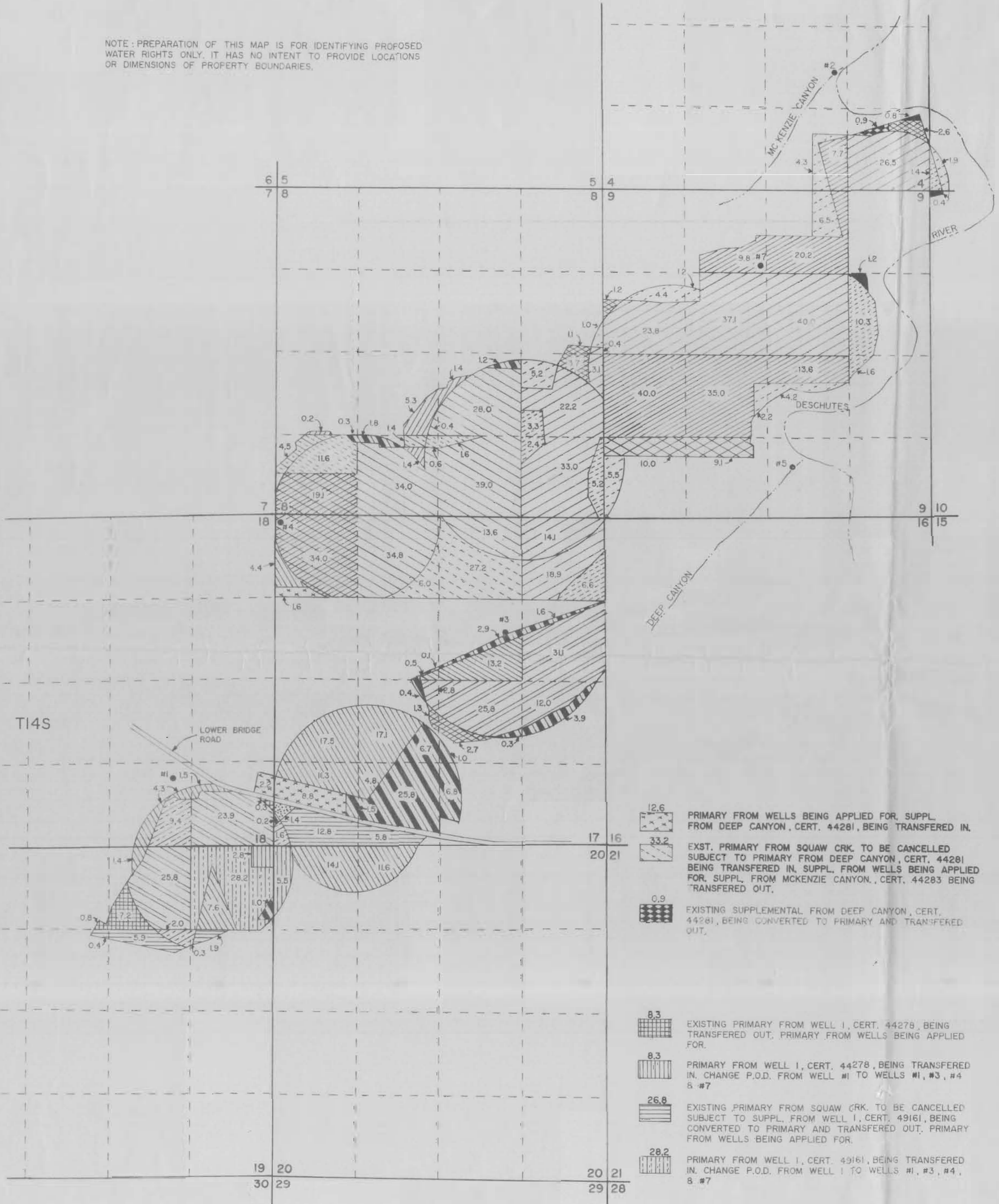

POINT OF DIVERSION TABLE

- # 1 WELL - 1050' NORTH & 6980' WEST FROM SE COR. SECTION 17
- # 2 MC KENZIE CANYON - 1870' NORTH & 3700' EAST FROM SW COR. SECTION 4
- # 3 WELL - 1900' SOUTH & 1500' WEST FROM NE COR. SECTION 17
- # 4 WELL - 120' SOUTH & 60' EAST FROM NW COR. SECTION 17
- # 5 DEEP CANYON - 4440' SOUTH & 3020' EAST FROM NW COR. SECTION 9
- # 7 WELL - 1220' SOUTH & 2540' EAST FROM NW COR. SECTION 9

LEGEND

- 12.6 EXISTING SUPPLEMENTAL FROM DEEP CANYON CRK. CERT. 44281, TO BE TRANSFERRED OUT.
- 2.4 EXISTING PRIMARY FROM DEEP CANYON CRK., CERT. 44281, TO BE TRANSFERRED OUT.
- 126.3 EXISTING PRIMARY FROM DEEP CANYON CRK., CERT. 44281, TO REMAIN IN PLACE WITH SUPPLEMENTAL FROM MCKENZIE CANYON, CERT. 44283, TO BE TRANSFERRED OUT. SUPPL. FROM WELLS BEING APPLIED FOR.
- 30.8 EXISTING PRIMARY FROM DEEP CANYON CRK., CERT. 44281, TO REMAIN IN PLACE. SUPPLEMENTAL FROM WELLS BEING APPLIED FOR.
- 219.1 EXISTING PRIMARY FROM SQUAW CRK. TO BE CANCELLED SUBJECT TO EXST. SUPPL. FROM DEEP CANYON CRK., CERT. 44281, BEING CONVERTED TO PRIMARY AND REMAIN. SUPPL. FROM WELLS APPLIED FOR.
- 36.4 PRIMARY FROM DEEP CANYON CRK., CERT. 44281, BEING TRANSFERRED IN. SUPPL. FROM WELLS BEING APPLIED FOR.
- 19.1 EXIST. PRIMARY FROM MCKENZIE CANYON, CERT. 44283, TO BE CONVERTED TO SUPPLEMENTAL AND TRANSFERRED OUT. PRIMARY FROM DEEP CANYON, CERT. 44281, TRANSFERRED IN. SUPPL. WELLS APPLIED FOR.
- 13.7 EXST. PRIMARY FROM DEEP CANYON, CERT. 44281, TO BE TRANSFERRED OUT. PRIMARY FROM WELLS BEING APPLIED FOR SUPPL. FROM MCKENZIE CANYON, CERT. 44283, BEING TRANSFERRED IN.
- 71.7 EXST. PRIMARY FROM SQUAW CRK. TO BE CANCELLED SUBJECT TO EXST. SUPPL. FROM DEEP CANYON, CERT. 44281, BEING CONVERTED TO PRIMARY AND TRANSFERRED OUT. PRIMARY FROM WELLS BEING APPLIED FOR. SUPPL. FROM MCKENZIE CANYON, CERT. 44283, BEING TRANSFERRED IN.
- 95.6 PRIMARY FROM WELLS BEING APPLIED FOR.
- 1.4 EXISTING PRIMARY FROM WELL 1, CERT. 49161, TO BE TRANSFERRED OUT. PRIMARY FROM WELLS BEING APPLIED FOR.
- 13.8 EXISTING PRIMARY FROM MCKENZIE CANYON, CERT. 44283, TO BE CONV. TO SUPPL. AND REMAIN IN PLACE. PRIMARY FROM WELLS APPLIED FOR.
- 5.9 EXISTING PRIMARY FROM MCKENZIE CANYON, CERT. 44283, TO BE CONV. TO SUPPL. AND TRANS. OUT.
- 54.3 PRIMARY FROM WELLS BEING APPLIED FOR. SUPPL. FROM MCKENZIE CANYON, CERT. 44283, BEING TRANSFERRED IN.
- 8.3 EXIST. SUPPLEMENTAL FROM MCKENZIE CANYON, CERT. 44283, TO BE TRANSFERRED OUT.
- 149.8 EXST. PRIMARY FROM SQUAW CRK. TO BE CANCELLED SUBJECT TO EXST. SUPPLEMENTAL FROM MCKENZIE CANYON, CERT. 44283, REMAINING IN PLACE AND PRIMARY FROM WELLS BEING APPLIED FOR.
- 53.1 EXISTING PRIMARY FROM SQUAW CREEK TO BE CANCELLED SUBJECT TO PRIMARY FROM WELLS BEING APPLIED FOR. SUPPL. FROM MCKENZIE CANYON, CERT. 44283, BEING TRANSFERRED IN.
- 49.7 EXST. PRIMARY FROM WELL 1, CERT. 44278, TO REMAIN IN PLACE. CHANGE P.O.D. FROM WELL #1 TO WELLS #1, #3, #4, #7.
- 1.2 EXISTING PRIMARY FROM WELL 1, CERT. 49161, TO REMAIN IN PLACE. CHANGE P.O.D. FROM WELL #1 TO WELLS #1, #3, #4, #7.
- 13.3 EXST. PRIMARY FROM SQUAW CRK. TO BE CANCELLED SUBJECT TO SUPPLEMENTAL FROM WELL 1, CERT. 49161, BEING CONVERTED TO PRIMARY. CHANGE P.O.D. FROM WELL #1 TO WELLS #1, #3, #4, #7.
- SECTION LINE
- 1/4, 1/4 SECTION LINE
- #1 • POINT OF DIVERSION AS NOTED IN TABLE

T14S

R12E



PREPARED FOR:
BIG FALLS RANCH CO.
P.O. BOX 434
TERREBONNE, OREGON 97760
(503) 548-8954

PREPARED BY:
ANDERSON ENGINEERING & SURVEYING
344 SW 7TH STREET
REDMOND, OREGON 97756
(503) 923-4307
OCT. 15, 1990 SHEET 1 OF 3