

MAP TO ACCOMPANY APPLICATION FOR PERMIT TO APPROPRIATE THE PUBLIC WATERS OF THE STATE OF OREGON.

LOCATED WITHIN T35, R9E, W.M. HOOD RIVER COUNTY, OREGON

MEADOWS WATER COMPANY, AN OREGON CORPORATION MT. HOOD, OREGON



1" = 400'

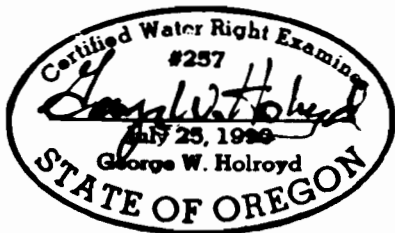
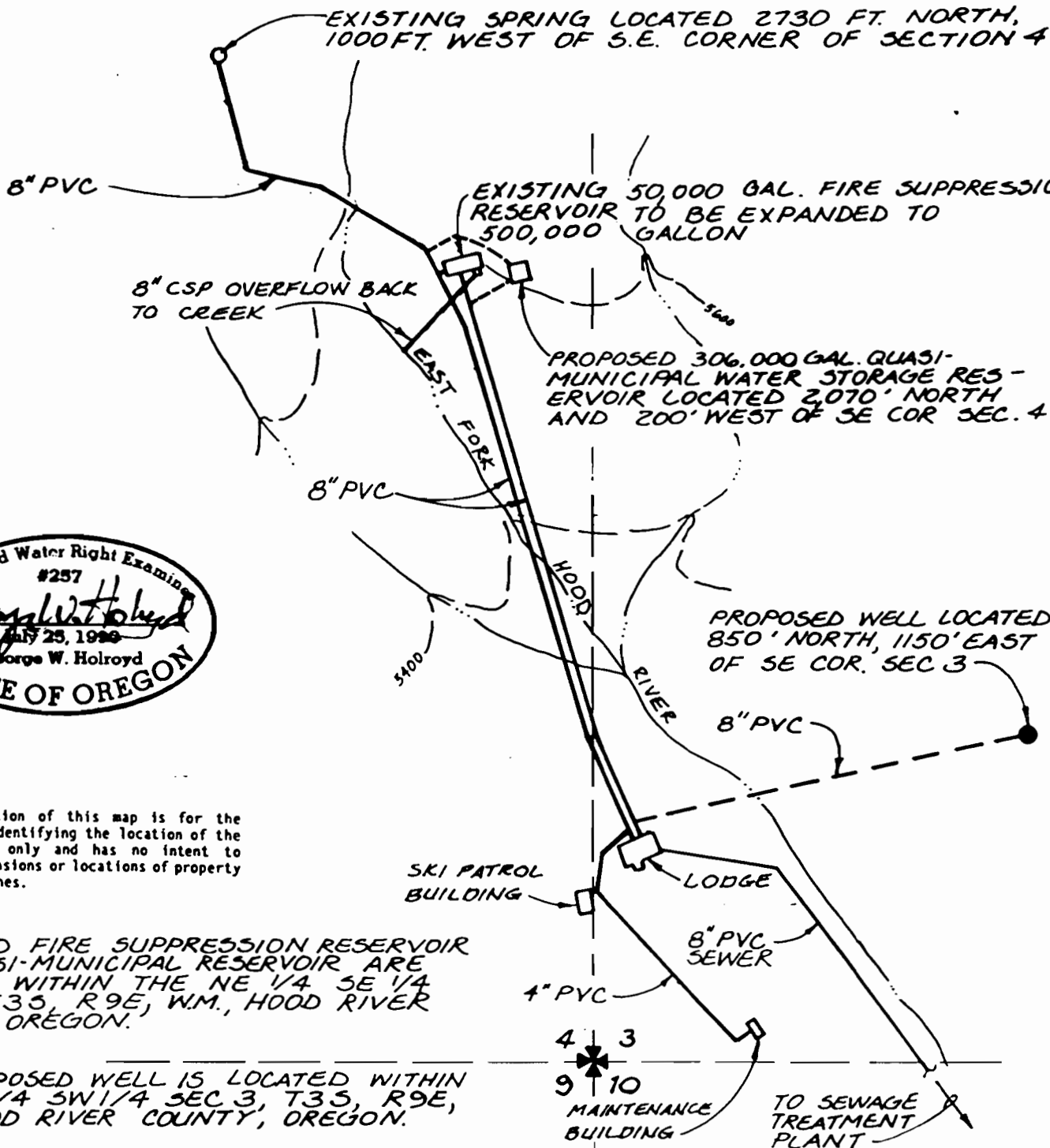

The preparation of this map is for the purpose of identifying the location of the water right only and has no intent to provide dimensions or locations of property ownership lines.

EXPANDED FIRE SUPPRESSION RESERVOIR AND QUASI-MUNICIPAL RESERVOIR ARE LOCATED WITHIN THE NE 1/4 SE 1/4 SEC 4, T35, R9E, W.M., HOOD RIVER COUNTY, OREGON.

THE PROPOSED WELL IS LOCATED WITHIN THE SW 1/4 SW 1/4 SEC 3, T35, R9E, W.M., HOOD RIVER COUNTY, OREGON.

DESIGN BY: JSE	DATE: MAY 1991	FIRE SUPPRESSION RESERVOIR APPLICATION MAP	CENTURY WEST ENGINEERING
DRAWN BY: PAM	JOB NO. 10578.006.D2		