

FINAL PROOF MAP
 FOR
 PERMIT G-13401
 COUNTRY SQUIRE ESTATES
 C/O MIKE JEWETT
 T4S R28E WM

RECEIVED
 9/02/03
 09:19 AM

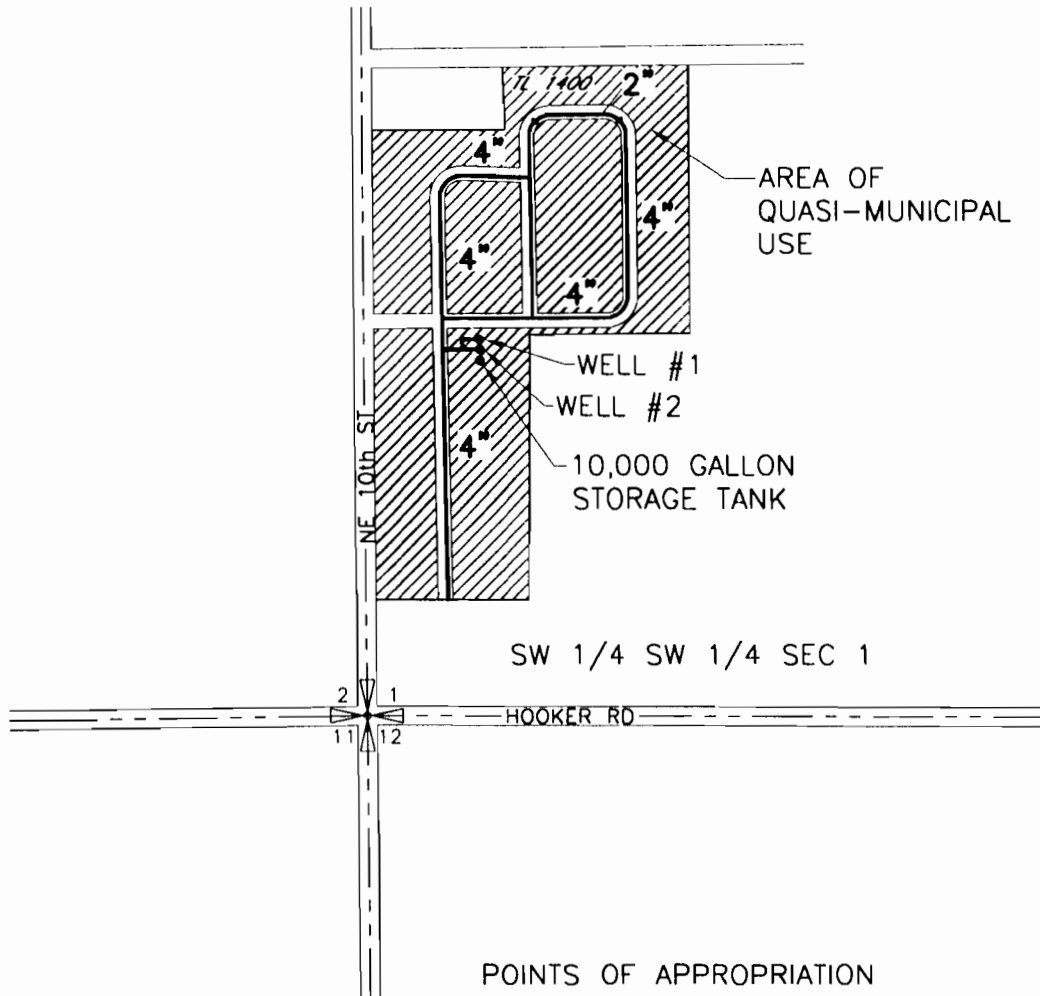

POINTS OF APPROPRIATION

WELL #1
 LOCATED 770'N AND 240'E FROM THE SW
 CORNER SEC 1

WELL #2
 LOCATED 750'N AND 240'E FROM THE SW
 CORNER SEC 1

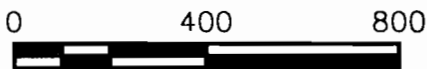
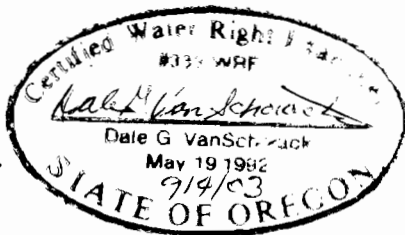

SCALE IN FEET

NOTE:
 THE PURPOSE OF THIS MAP IS TO IDENTIFY THE APPROXIMATE LOCATION
 OF THE WATER RIGHT. IT IS NOT INTENDED TO PROVIDE INFORMATION
 RELATIVE TO THE LOCATION OF PROPERTY OWNERSHIP BOUNDARY LINES.

SCM Consultants, Inc.
 A Tetra Tech Company

DRAWING: H:\CAD\AG\3522\164\3522164FP.dwg
 PRINTED BY: rogerw on 09/02/03 06:19 AM

9/02/03