

RECEIVED

SEP 02 1997

WATER RESOURCES DEPT.
SALEM, OREGON

T.6S.R.1W.W.M.

Application No. *61400*

Permit No. *G13409*

THEIR AREA PROPOSED
TO BE IRRIGATED
CONSISTS OF THE ACRES
ON THIS MAP & THE
MAP ON NEXT PAGE
RWK 3/5/98

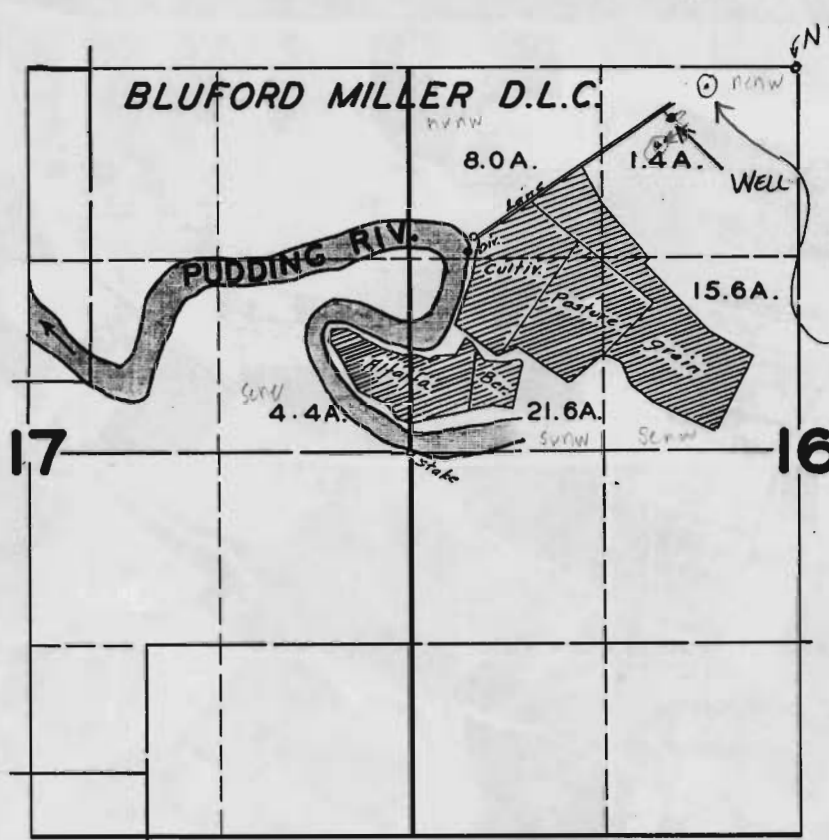

WELL
LOCATION
SUPERCEDED
SEE LETTER 1
MAP DATED
12/23/98
(NEW LOCATION IS
120 S & 630 W
FROM NE CORNER)

SUPPLEMENTAL
IRRIGATION
(primary
cert. 16735)

WELL IS LOCATED 350' SOUTH & 870' WEST FROM N 1/4 COR SEC. 16
530 960

APPLICATION MAP

WATER PROOF SURVEY

UNDER

Application No. _____ Permit No. _____

IN NAME OF

Surveyed JUN. 25 1947, by JAS. E. BUNNELL

(*APPL.#*
5-20469
1947-C)