

ME D F O R D

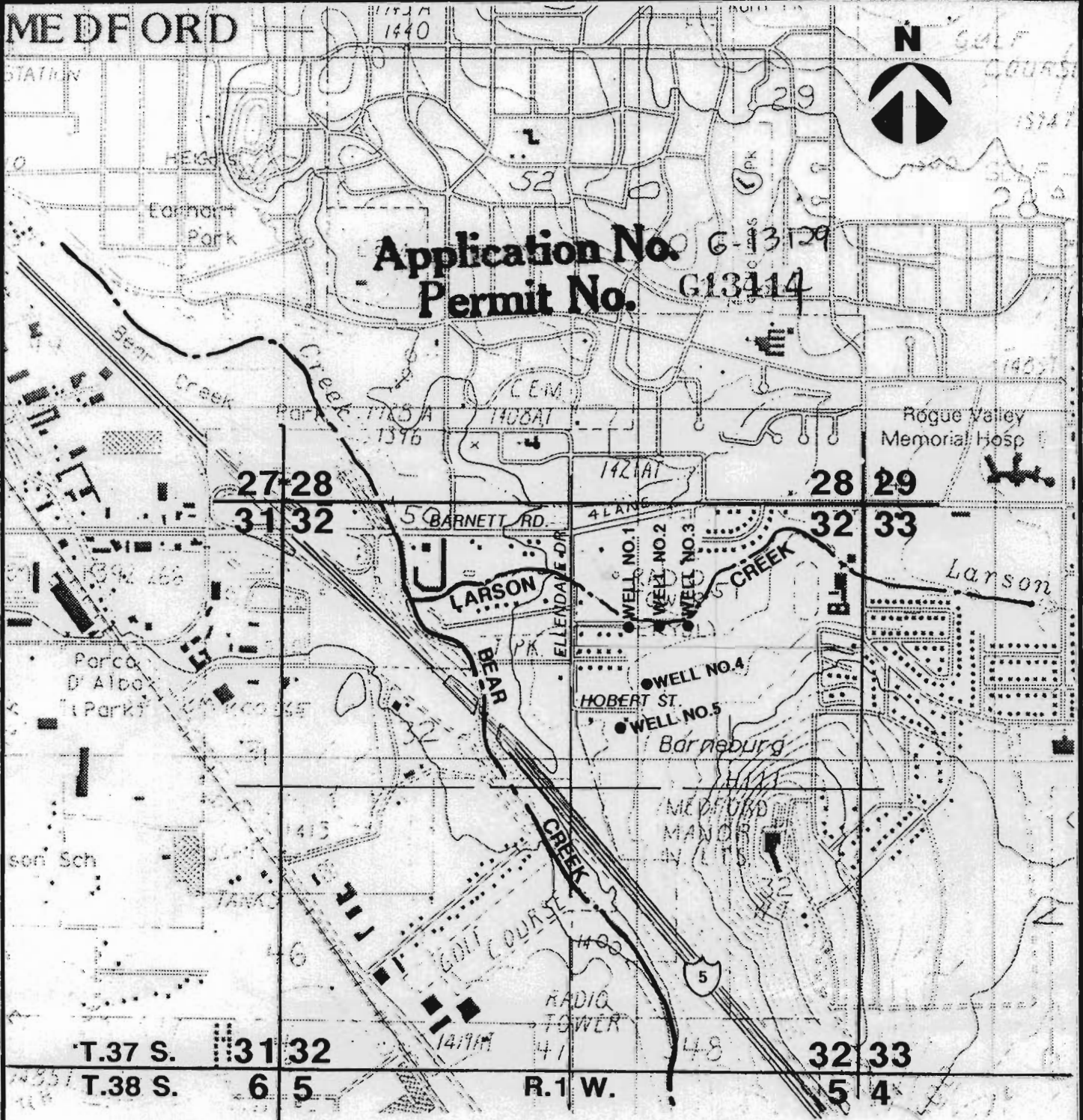

Application No. G-13129  
Permit No. G13114



Well No.	*Distance (Ft)		Ground Elev.
	North	East	
1	1578	577	1411
2	1588	820	1414
3	1636	1063	1418
4	998	627	1443
5	588	434	1423

\*From Center of 1/4 Section 32, T. 37 S., R. 1W., W. M.

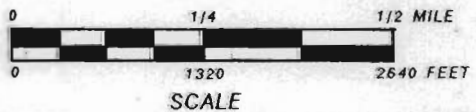

SCALE

NOTE: MAP IS FOR THE INTENDED PURPOSE OF WELLS APPLICATION AND DOES NOT INTEND TO DIMENSION PROPERTY OR OWNERSHIP LINES.

WELLS APPLICATION  
**RECEIVED** ROGUE VALLEY MANOR

SEP - 8 1992

WATER RESOURCES DEPT  
SALEM, OREGON

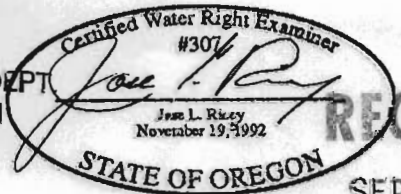

**RECEIVED**

SEP 22 1992

WATER RESOURCES DEPT  
SALEM, OREGON