

APPLICATION MAP

**RECEIVED**

IN THE NAME OF DAVE BROOKS

JUL 14 1997

SECTIONS 7 & 18, T 29 S, R 14 W, W.M.

WATER RESOURCES DEPT.  
SALEM, OREGON

*G14583*  
*TL No. G12415 G13415*



1 INCH = 1320 FEET

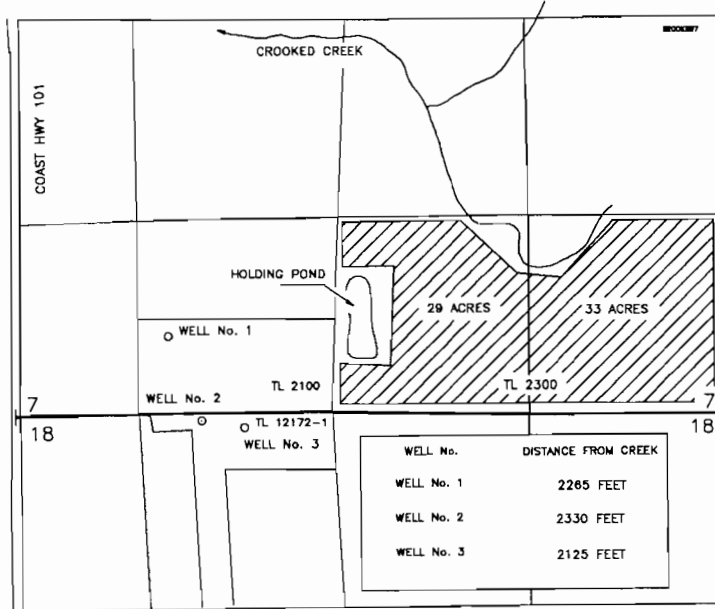

THE POINTS OF DIVERSIONS, THREE WELLS, ARE TO BE LOCATED AS FOLLOWS:

WELL No.	NORTH/SOUTH	EAST	SECTION	¼ ¼ SECTION
WELL No. 1	565 FEET NORTH	1,055 FEET	7	SE¼SW¼
WELL No. 2	20 FEET SOUTH	1,275 FEET	18	NE¼NW¼
WELL No. 3	70 FEET SOUTH	1,580 FEET	18	NE¼NW¼

ALL FROM THE NORTHWEST CORNER OF SECTION 18, TOWNSHIP 29 SOUTH, RANGE 14 WEST, W.M.  
AND WITHIN SECTIONS 7 AND 18, TOWNSHIP 29 SOUTH, RANGE 14 WEST, W.M., COOS COUNTY.

THE PURPOSE OF THIS MAP IS TO IDENTIFY THE LOCATION OF THE WATER RIGHT.  
IT IS NOT INTENDED TO PROVIDE INFORMATION RELATIVE TO THE LOCATION OF  
PROPERTY OWNERSHIP BOUNDARY LINES.