

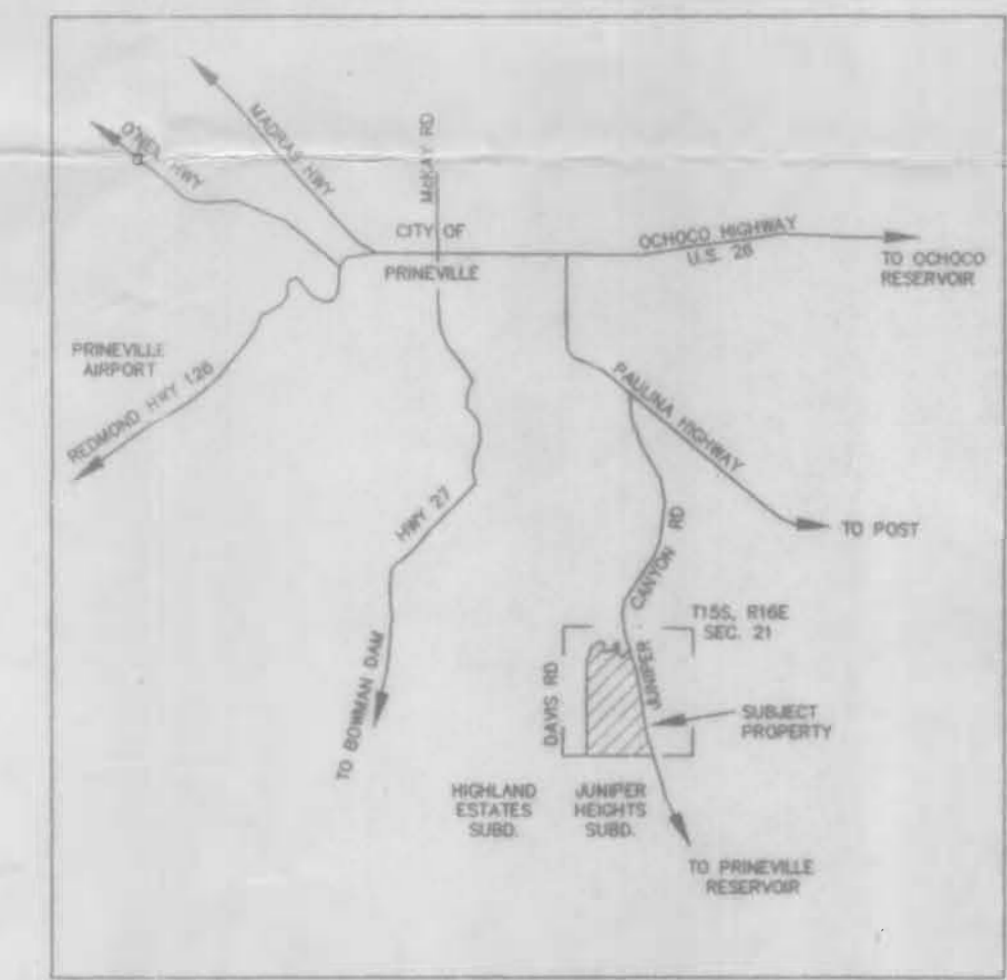

HIGH DESERT ESTATES  
 WATER RIGHTS APPLICATION MAP  
 LOCATED IN SECTION 21,  
 TOWNSHIP 15 SOUTH, RANGE 16 EAST, W.M.,  
 CROOK COUNTY, OREGON  
 PHASE THREE - 111 LOTS

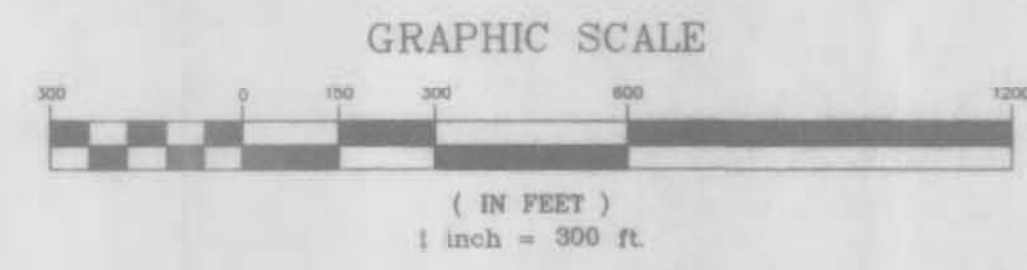

VICINITY MAP  
 NOT TO SCALE

WELL LOCATION:  
 WELL NO. 1 - 1123' EAST AND  
 290' NORTH OF THE SOUTHWEST  
 CORNER OF SECTION 21  
 WELL NO. 2 - 2759' EAST AND  
 190' NORTH OF THE SOUTHWEST  
 CORNER OF SECTION 21  
 WELL NO. 3 - 2520' EAST AND  
 1936' NORTH OF THE SOUTHWEST  
 CORNER OF SECTION 21

Application No. *6-14046*  
 Permit No. *63459*

I, William R. Tye, Certified Water Right Examiner  
 in the State of Oregon, hereby certify the above  
 application map was prepared under my direct  
 supervision.  
 The preparation of this map is for the purpose  
 of identifying the location of the water right only  
 and has no intent to provide dimensions or locations  
 of property ownership lines.



RECEIVED  
 MAR 31 1995  
 WATER RESOURCES DEPT.  
 SALEM, OREGON

**TYE ENGINEERING, INC.**  
 725 NW HILL - BEND, OREGON 97701 - (503) 389-6959

RECEIVED  
 APR 17 1995  
 WATER RESOURCES DEPT.  
 SALEM, OREGON

FOR:  
 MARK FLEMING  
 403820 ELLIOTT LN  
 PRINEVILLE, OR 97754

SHEET 1  
 OF 1  
 SHEETS

SCALE: 1"=300'  
 DATE: MARCH 15, 1995  
 DRAWN: P.A.T.  
 DWG #: 169

DWG NAME: 169-228