

APPLICATION MAP

IN THE NAME OF BURGUNDY HARVEST FARM, Inc.

SECTION 9, T 32 S, R 15 W, W.M.

Application No. **G14589**
 Permit No. **G13453**

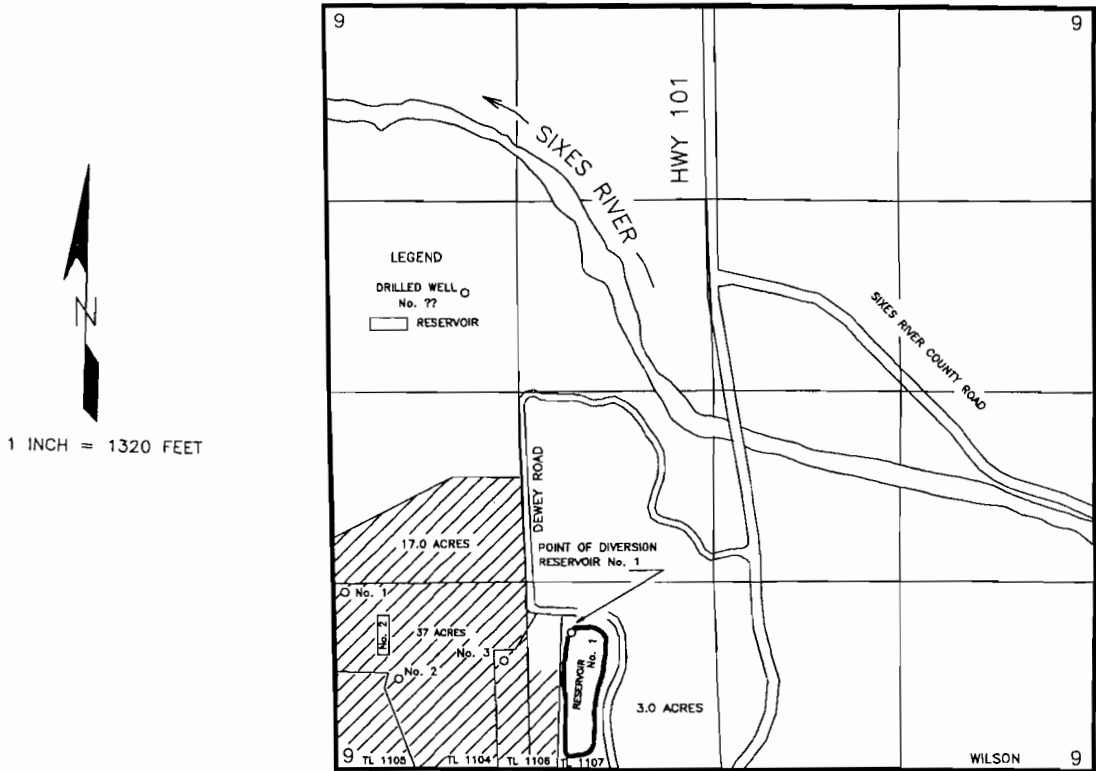

THE POINTS OF DIVERSIONS ARE TO BE LOCATED AS FOLLOWS:

SOURCE	SOUTH	EAST	COMMENT	¼ ¼	SECTION
Reservoir No. 1	1,660 feet	1,650 feet		SE¼SW¼	9
Reservoir No. 2	1,670 feet	370 feet	Center of Reservoir	SW¼SW¼	9
Well No. 1	1,395 feet	90 feet		SW¼SW¼	9
Well No. 2	1,990 feet	470 feet		SW¼SW¼	9
Well No. 3	1,860 feet	1,190 feet		SW¼SW¼	9

ALL FROM THE WEST QUARTER CORNER OF SECTION 9 AND WITHIN SECTION 9, TOWNSHIP 32 SOUTH, RANGE 15 WEST, W.M., CURRY COUNTY.

THE PURPOSE OF THIS MAP IS TO IDENTIFY THE LOCATION OF THE WATER RIGHT. IT IS NOT INTENDED TO PROVIDE INFORMATION RELATIVE TO THE LOCATION OF PROPERTY OWNERSHIP BOUNDARY LINES.