

TOTAL SERVED BY GROUP DOMESTIC EXPANDED: 20 LOTS

SECTION 36
T.14 S., R.15 E., W.M.
CROOK COUNTY, OREGON

 SERVICE AREA

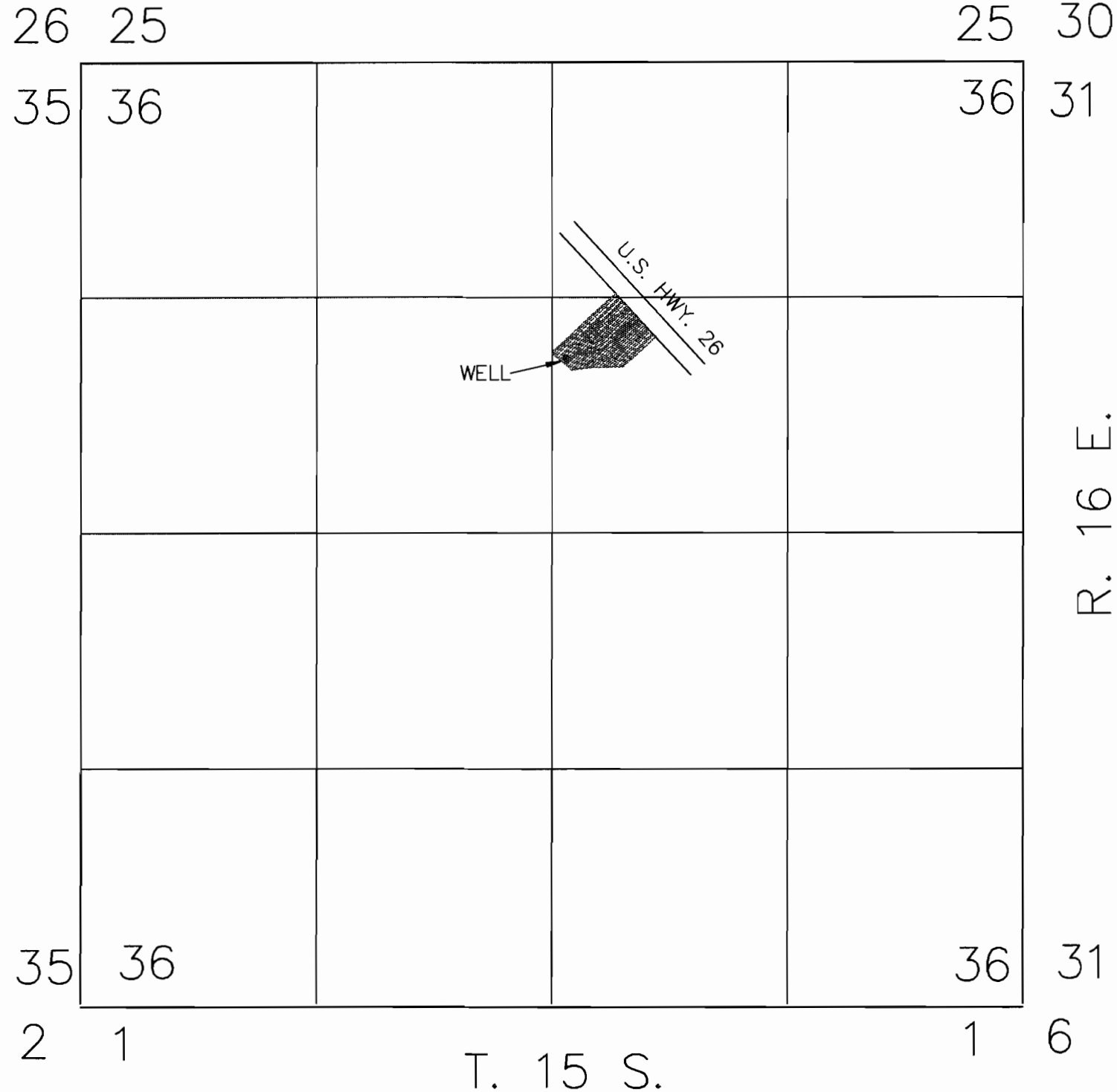

APPLICATION FOR PERMIT TO
APPROPRIATE GROUND WATER FOR:

JOE NELSON
P.O. BOX 706
PRINEVILLE, OREGON 97754

Application No. *G-13556*
Permit No. *111516*

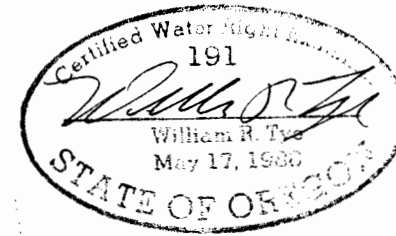
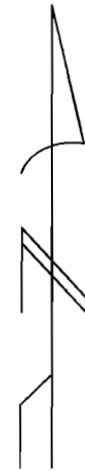

1" = 800'

I, William R. Tye, Certified Water Right Examiner in
the State of Oregon, hereby certify the above application
map was prepared under my direct supervision.

The preparation of this map is for the purpose of identifying
the location of the water right only and has no intent to
provide dimensions or locations of property ownership lines.

WELL IS LOCATED 867 FEET SOUTH AND 114 FEET EAST
OF THE NORTH 1/4 CORNER OF SECTION 36 T. 14 S.
R. 15 E., W.M. CROOK COUNTY, OREGON

TYE ENGINEERING, INC.

112 NW GREELEY AVENUE, BEND, OREGON 97701 (503) 389-6959

APPLICATION FOR PERMIT TO
APPROPRIATE GROUND WATER FOR:

JOE NELSON
P.O. BOX 706
PRINEVILLE, OREGON 97754