

W.R. 686

# LYLE BOWERS

SEC. 32, T. 12 S., R. 1 W., W.M., LINN CO., ORE.

Scale: 1" = 10 Chains

May 4, 1959

ORRIS A. CARNEGIE  
DEP. CO. SURVEYOR

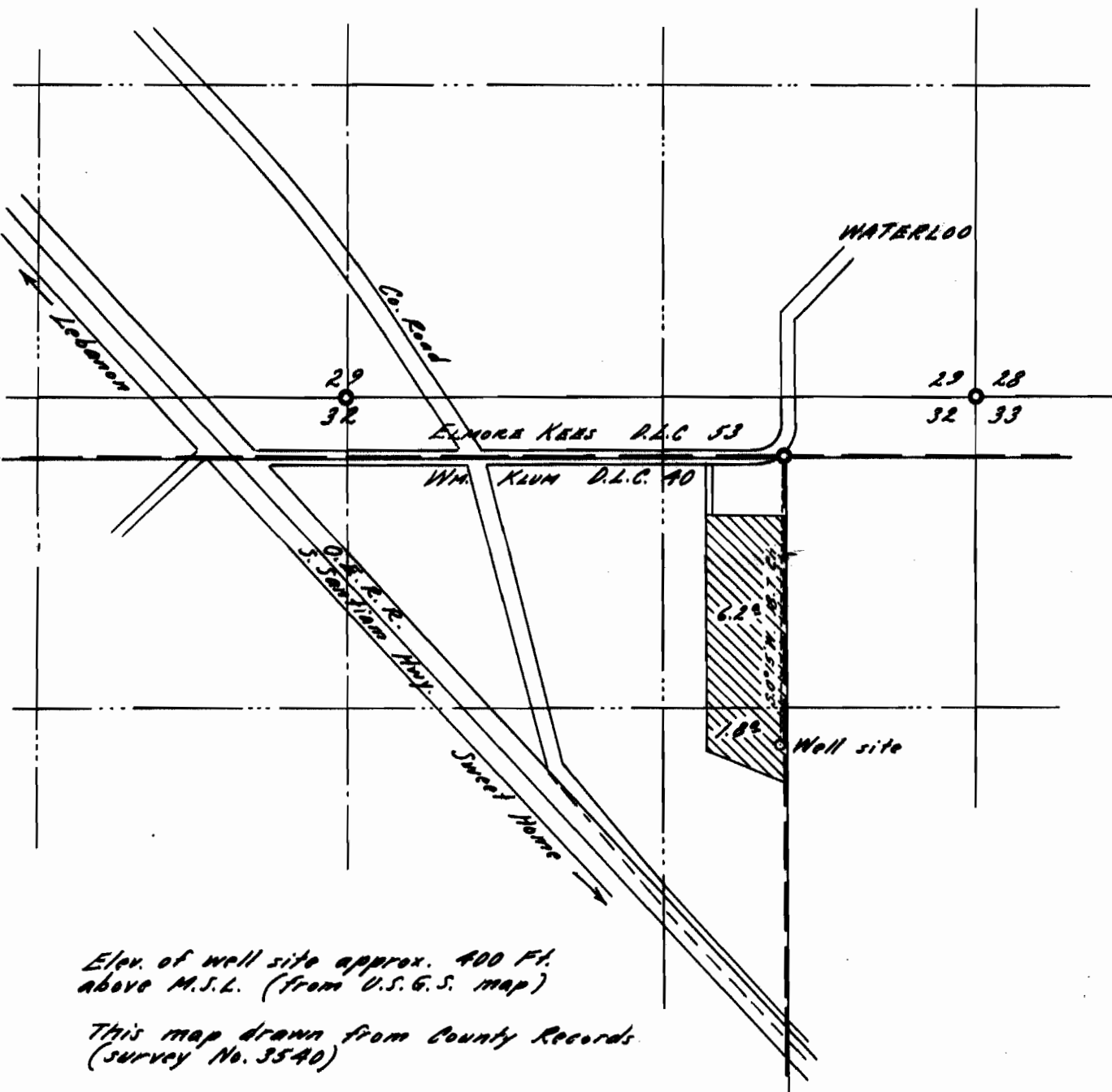

Elev. of well site approx. 400 Ft.  
above M.S.L. (from U.S.G.S. map)

This map drawn from County Records  
(survey No. 3540)

REGISTERED  
OREGON  
LAND SURVEYOR

*Orris A. Carnegie*

MAY 9, 1947  
ORRIS A. CARNEGIE  
213

Application No. C-1474  
Permit No. C-1352

RECEIVED  
MAY 18 1959  
STATE ENGINEER  
SALVAGE SECTION