

T.4S. R.1E. Section 21, W.M.

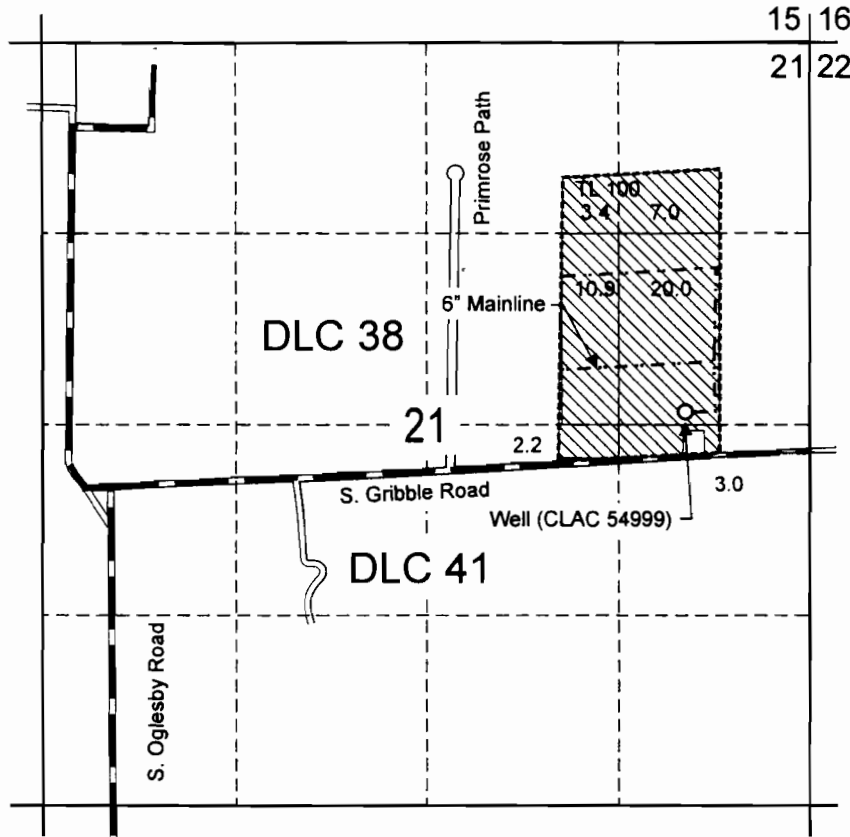

RECEIVED

03 10 2005

RECEIVED
SALEM, OREGON

Well 1 (CLAC 54999) is located 2,550 feet south and 860 feet west from the NE corner of Section 21.

 Area (46.5 Acres) irrigated under Application G-14821, Permit G-13635.

----- Tax lot boundary



EXPIRATION DATE 6/30/07

Scale: 1" = 1,320'

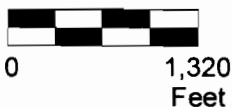

This map was prepared for the purpose of identifying the location of a water right only and is not intended to provide legal dimensions or location of property ownership lines.



Claim of Beneficial Use Map
Application G-14821, Permit G-13635

Pacific Hydro-Geology Inc.

Moana H&N

3/2005