

app 614768  
per. 91808

CITY OF MT. ANGEL

T6S  
R1W

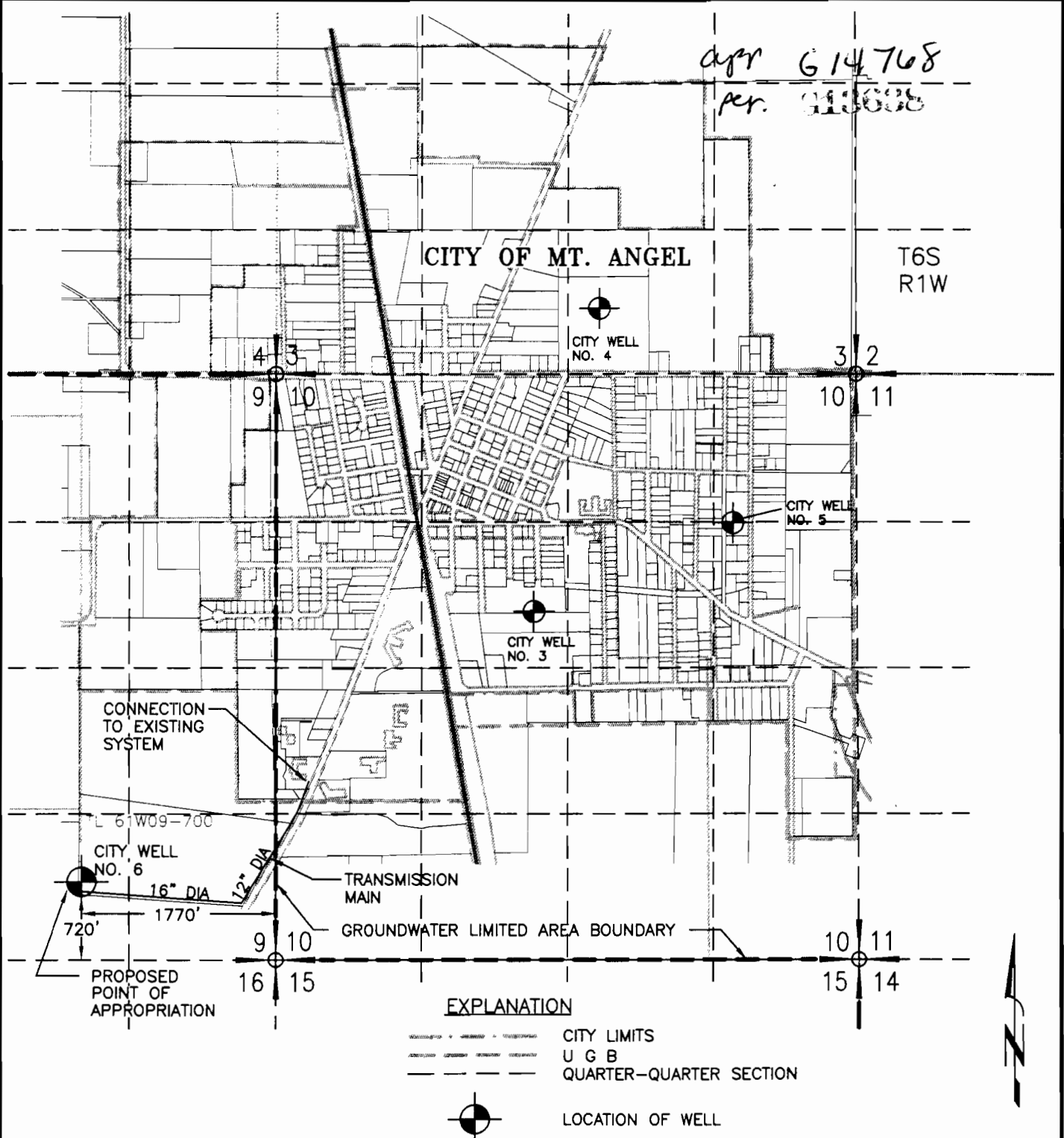

EXPLANATION

- CITY LIMITS
- U G B
- QUARTER-QUARTER SECTION
- LOCATION OF WELL

NOTE:  
THIS MAP WAS PREPARED FOR THE PURPOSE OF IDENTIFYING THE LOCATION OF WATER RIGHT ONLY AND IS NOT INTENDED TO PROVIDE LEGAL DIMENSIONS OR LOCATIONS OF PROPERTY OWNERSHIP LINES.

TOWNSHIP 6 SOUTH, RANGE 1 WEST, W.M.

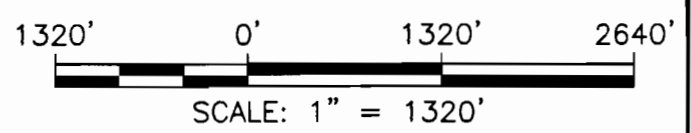

**DAVID J. NEWTON ASSOCIATES, INC.**  
CIVIL & GEOLOGICAL ENGINEERING SERVICES  
1201 S.W. 12TH AVENUE, SUITE 400  
PORTLAND, OREGON 97205  
(503) 228-7718  
FAX (503) 228-7781

**APPLICATION FOR A PERMIT TO USE  
GROUNDWATER - CITY WELL NO. 6**

DATE	FILE NAME	INITIALS	PROJECT NO.	FIGURE
NOV. 1998	NEWRIGHT	TIW	322-113	CITY OF MT. ANGEL, OREGON