

RECEIVED

MAR 24 1995

WATER RESOURCES DEPT.
SALEM, OREGON

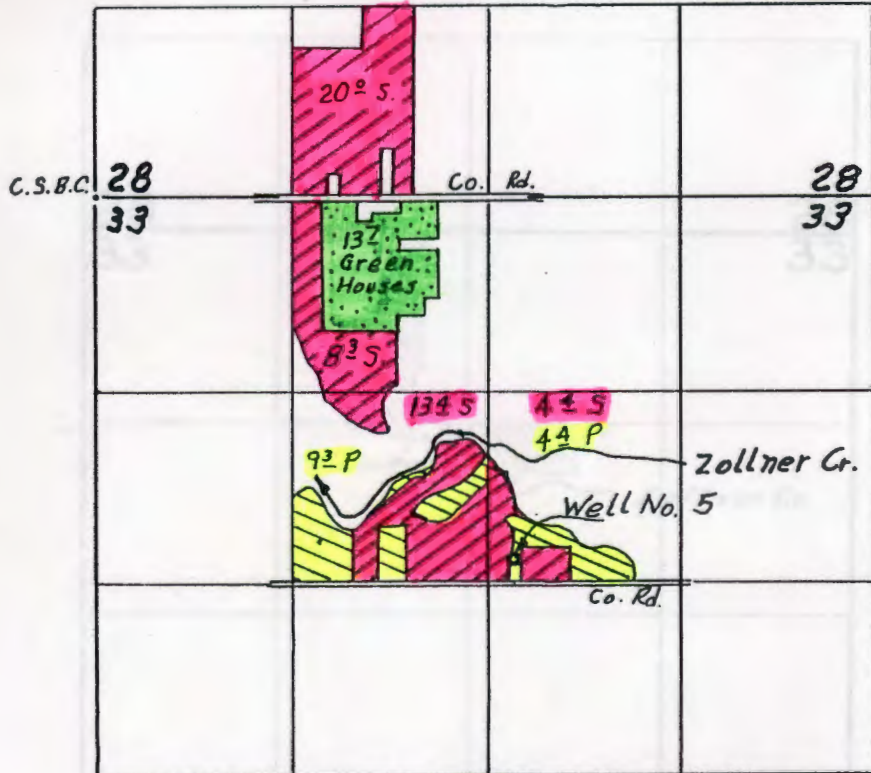

T. 5 S. R. 1 W. W. M.

13.7 - Primary
46.1 - Supplemental

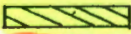

Scale
4" = 1 Mi.

Well No. 5 loc. 2480'S of 2830'E from NW cor. Sec. 33

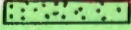
-  Primary Irrig.
-  Suppl.
-  Greenhouses

Application No. 6-14013
Permit No.

WATER RIGHT MAP FOR
ROBERT FESSLER

THIS MAP WAS PREPARED FOR THE PURPOSE OF IDENTIFYING THE LOCATION OF A WATER RIGHT ONLY AND IS NOT INTENDED TO PROVIDE LEGAL DIMENSIONS OR LOCATION OF PROPERTY OWNERSHIP LINES.

